

CHANNEL FUNCTION

A.LEDA B-EYE K10 CC

A.LEDA B-EYE K20 CC

NB: To prevent accidental breakage of the effects, which could collide with each other during transport, before switching the projector OFF check that all the projector Channels have been excluded (DMX level @0 bit).

CHANNEL	CHANNEL MODE
1	Red
2	RedFine
3	Green
4	GreenFine
5	Blue
6	BlueFine
7	White
8	WhiteFine
9	CTO
10	Macro Colour
11	Strobe
12	Dimmer
13	Dimmer fine
14	Pan
15	Pan fine
16	Tilt
17	Tilt fine
18	Function
19	Reset
20	Zoom

NOTE: On conclusion of resetting in case of absence of DMX signal, Pan & Tilt move to the "Home" position (Pan 128 bit - Tilt 128 bit) all the others channels stay at 0 bit.

- (1 - 3 - 5 - 7)
RED - GREEN - BLUE - WHITE

K10 CC
K20 CC



BIT	EFFECT
255	LED ON
0	LED OFF

- (2 - 4 - 6 - 8)
RED FINE - GREEN FINE - BLUE FINE - WHITE FINE

K10 CC
K20 CC



BIT	EFFECT
255	UP
0	LOW

- (9)
LINEAR CTO

K10 CC
K20 CC

BIT	EFFECT
255	2500 K
...	...
224	3200 K
...	...
188	4000 K
...	...
144	5000 K
...	...
117	5600 K
...	...
99	6000 K
...	...
54	7000 K
...	...
10	8000 K
0-9	UNUSED RANGE

- (10)
MACRO COLOUR

K10 CC
K20 CC

BIT	LEE REFERENCE	COLOUR	BIT VALUE			
			R	G	B	W
209-255	-	White	255	235	66	255
208	-	Dirty White	255	255	122	255
207	197	Alice Blue	128	255	143	0
191-206	181	Congo Blue	76	0	255	0
184-190	174	Dark Steel Blue	158	247	89	0
180-183	170	Deep lavender	232	165	58	0
179	169	Lilac Tint	246	208	45	0
175-178	165	Daylight Blue	75	218	90	0
174	164	Flame Red	211	27	2	0
172-173	162	Bastard Amber	227	176	23	0
168-171	158	Deep Orange	227	86	1	0
162-167	152	Pale Gold	255	189	24	0
157-161	147	Apricot	231	142	11	0
151-156	141	Bright Blue	0	243	79	0
149-150	139	Primary Green	59	229	1	0
147-148	137	Special lavender	199	197	74	0
146	136	Pale Lavender	225	196	54	0
145	135	Deep Golden Amber	255	48	1	0
142-144	132	Medium Blue	0	239	135	0
138-141	128	Bright Pink	239	40	31	0
136-137	126	Mauve	213	28	50	0
134-135	124	Dark Green	67	237	10	2
131-133	121	Leaf Green	171	232	1	0
129-130	119	Dark Blue	0	194	253	0
128	118	Light Blue	62	255	76	0
127	117	Steel Blue	185	255	48	0
126	116	Med Blu Green	185	255	48	0
125	115	Peacock Blue	39	249	43	0
123-124	113	Magenta	158	6	8	0
121-122	111	Dark Pink	225	107	27	0
120	110	Middle Rose	209	132	24	0
119	109	Light Salmon	240	141	27	0
118	108	English Rose	220	140	18	0
117	107	Light Rose	251	152	28	0
115-116	105	Orange	255	131	1	0
114	104	Deep Amber	243	172	1	0
113	103	Straw	216	158	0	80
112	102	Light Amber	210	158	1	0
110-111	100	Spring Yellow	220	199	1	0
100-109	90	Dark yellow green	35	225	1	0
89-99	79	Just Blue	0	190	129	0
78-88	68	Sky Blue	0	251	133	0
68-77	58	Lavender	220	117	146	199
62-67	52	Light Lavender	237	125	39	203
49-61	39	Pink Carnation	232	95	0	146
46-48	36	Medium Pink	255	79	0	130
45	35	Light Pink	228	102	0	156
35-44	25	Sunrise Red	249	83	2	0
32-34	22	Dark Amber	255	59	1	0
31	21	Gold Amber	214	90	1	0
30	20	Medium Amber	213	125	1	0
29	19	Fire	241	42	1	0
27-28	17	Surprise Peach	201	119	8	0
23-26	13	Straw Tint	197	149	10	0
20-22	10	Medium Yellow	177	148	1	0
19	-	Black	0	0	0	0
18	-	White 5000 K	251	137	0	229
17	-	White 3700 K	255	201	25	255
16	-	White 7000 K	175	227	59	255
15	-	Magenta	255	0	255	0
14	-	Yellow	226	255	1	0
13	-	Cyan	0	255	245	0
12	-	Blue	0	0	255	0
11	-	Green	0	255	0	0
10	-	Red	255	0	0	0
0-9	-	Macro color OFF	-	-	-	-

• (11)
STROBE

K10 CC
K20 CC



BIT	EFFECT
252 - 255	LED ON
239 - 251	RANDOM FAST STROBE
226 - 238	RANDOM MEDIUM STROBE
213 - 225	RANDOM SLOW STROBE
208 - 212	LED ON
207	FAST PULSATION (25 flash/sec)
108	SLOW PULSATION (0,5 flash/sec)
104 - 107	LED ON
103	FAST STROBE (25 flash/sec)
4	SLOW STROBE (1 flash/sec)
0 - 3	LED OFF

• (12)
DIMMER

K10 CC
K20 CC



BIT	EFFECT
255	LED ON
0	LED OFF

• (13)
DIMMER FINE

K10 CC
K20 CC



BIT	EFFECT
255	UP
0	LOW

• (14)
PAN

Operation with option InvertPan \diamond Off

K10 CC
K20 CC

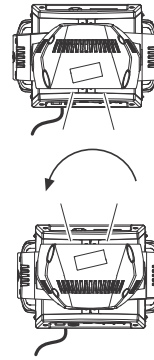

BIT
255
0

Operation with option InvertPan \diamond On

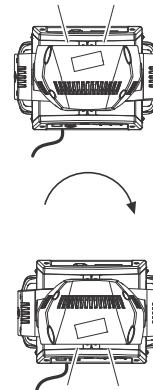

BIT
255
0

• (15)
PAN FINE

Operation with option InvertPan \diamond Off

K10 CC
K20 CC

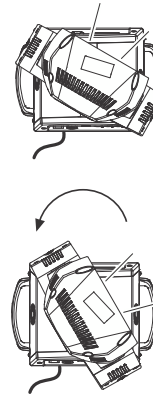

BIT
255
0

Operation with option InvertPan \diamond On

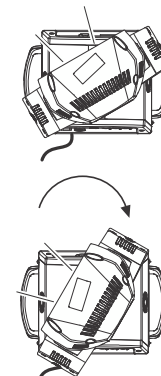

BIT
255
0

- (16)
TILT
Operation with option *InvertTilt* \diamond Off

K10 CC
K20 CC



BIT
255
0

- Operation with option *InvertTilt* \diamond On



BIT
255
0

- (17)
TILT FINE
Operation with option *InvertTilt* \diamond Off

K10 CC
K20 CC

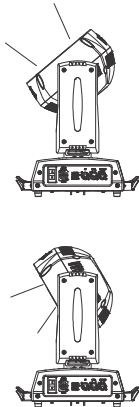

BIT
255
0

- Operation with option *InvertTilt* \diamond On

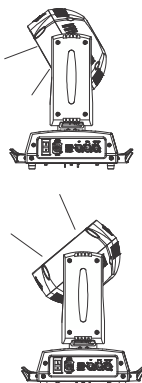

BIT
255
0

- (18)
FUNCTION
K10 CC
K20 CC

BIT	EFFECT
251 – 255	Reset to default
103 – 250	Unused Range
98 – 102	Halogen Lamp Simulation, type 5 (2500 W)
93 – 97	Halogen Lamp Simulation, type 4 (2000 W)
88 – 92	Halogen Lamp Simulation, type 3 (1200 W)
83 – 87	Halogen Lamp Simulation, type 2 (1000 W)
78 – 82	Halogen Lamp Simulation, type 1 (750W)
73 – 77	Halogen Lamp Simulation OFF (Default)
68 – 72	RGBW Gamma curve 3 – gamma = 2,0
63 – 67	RGBW Gamma curve 2 – gamma = 1,5 (Default)
58 – 62	RGBW Gamma curve 1 – gamma = 1,0
53 – 57	Dimmer Curve 4
48 – 52	Dimmer Curve 3
43 – 47	Dimmer Curve 2
38 – 42	Dimmer Curve 1 (Default)
25 – 37	Pan Tilt Normal
12 – 24	Pan Tilt Fast (Default)
0 – 11	Function off

The functions are activated passing through the “unused range” and staying 5 seconds in necessary level. Last selected function still active. Enable setting a new function.

DIMMER CURVE 1 - GAMMA 1 LINEAR

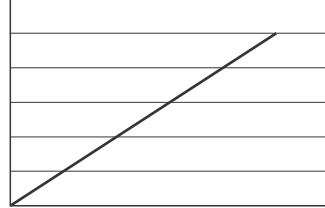

DIMMER CURVE 2 - GAMMA 1,5

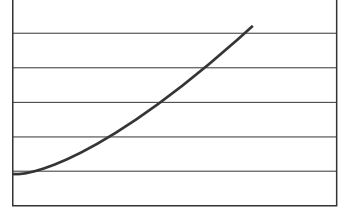

DIMMER CURVE 3 - GAMMA 2,0

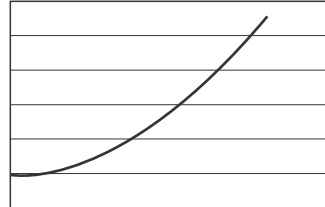

DIMMER CURVE 4 - S

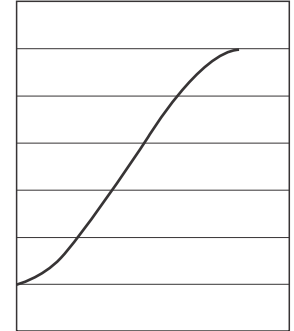

- (19)
RESET

K10 CC
K20 CC

BIT	EFFECT
255	COMPLETE RESET
	Complete reset is activated passing through the unused range and staying 5 seconds in complete reset levels
128	COMPLETE RESET
127	PAN / TILT RESET
	Pan / Tilt reset is activated passing through the unused range and staying 5 seconds in Pan / Tilt reset levels
77	PAN / TILT RESET
76	ZOOM RESET
	Effects reset is activated passing through the unused range and staying 5 seconds in Effects reset levels.
26	ZOOM RESET
25	
0	UNUSED RANGE

The functions are activated passing through the “unused range” and staying 5 seconds in necessary level. Last selected function still active. Enable setting a new function.

- (20)
ZOOM

K10 CC
K20 CC



BIT	EFFECT
255	WIDE BEAM
0	NARROW BEAM