

INSTRUCTION MANUAL

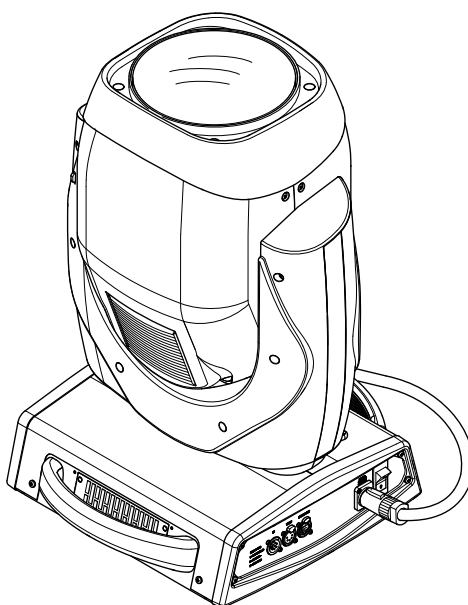

INDEX

Page	Contents
2	Safety information
3	Unpacking and preparation
4	Installation and start-up
5	Control panel
7	Maintenance
15	Technical information
16	Cause and solution of problems

*Congratulations on choosing a Claypaky product!
We thank you for your custom.*

Please note that this product, as all the others in the rich Claypaky range, has been designed and made with total quality to ensure excellent performance and best meet your expectations and requirements.

SAFETY INFORMATION

EN

SAFETY INSTRUCTIONS

IMPORTANT: Claypaky recommends you carefully read and keep the safety information on this product, also available in digital format at the following link:

www.claypaky.com

Ref: [FIS00H - Safety Information Supersharpy-Mythos-Hepikos]

IT

INFORMAZIONI DI SICUREZZA

IMPORTANTE: Claypaky raccomanda di leggere accuratamente e conservare le informazioni di sicurezza relative a questo prodotto, sempre reperibili in versione digitale al seguente link:

www.claypaky.com

Rif: [FIS00H - Safety Information Supersharpy-Mythos-Hepikos]

DE

INFORMATIONEN ZUR SICHERHEIT

WICHTIG: Claypaky empfiehlt, die Sicherheitsinformationen bezüglich dieses Produkts genau zu lesen und aufzubewahren. Sie sind in Digitalversion immer unter folgendem Link auffindbar:

www.claypaky.com

Ref: [FIS00H - Safety Information Supersharpy-Mythos-Hepikos]

ES

INFORMACIONES DE SEGURIDAD

IMPORTANTE: Claypaky recomienda leer detenidamente y conservar la información de seguridad relativa a este producto. Además, está disponible una versión digital de la misma en el siguiente enlace:

www.claypaky.com

Ref: [FIS00H - Safety Information Supersharpy-Mythos-Hepikos]

FR

CONSIGNES DE SÉCURITÉ

IMPORTANT: Claypaky recommande de lire attentivement et de conserver les informations de sécurité relatives à ce produit, disponibles en version digitale au lien suivant:

www.claypaky.com

Réf. : [FIS00H - Safety Information Supersharpy-Mythos-Hepikos]

RU

ИНСТРУКЦИЮ ПО ТЕХНИКЕ БЕЗОПАСНОСТИ

ВАЖНО: Клаупаку рекомендует внимательно прочитать и сохранить инструкцию по технике безопасности данного изделия, которая всегда доступна в электронном формате по следующей ссылке:

www.claypaky.com

Наименование: [FIS00H - Safety Information Supersharpy-Mythos-Hepikos]

UNPACKING AND PREPARATION

1

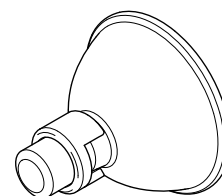
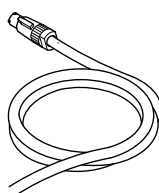
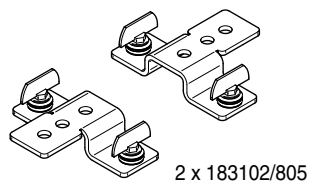

LAM00N
(fitted into fixture)

Packing contents - Fig. 1

2

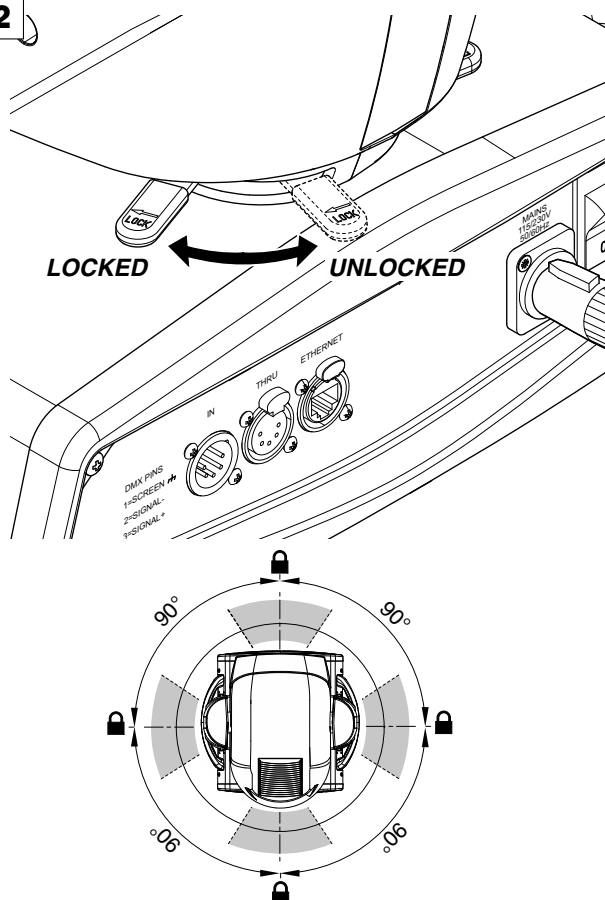

PAN Mechanism Lock and Release (every 90°) - Fig. 2

3

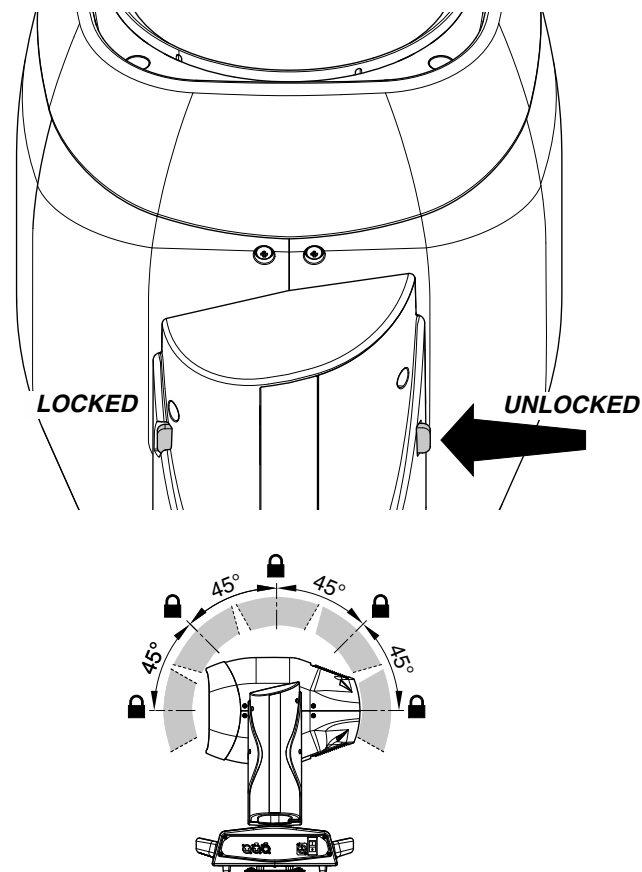

TILT Mechanism Lock and Release (every 45°) - Fig. 3

4

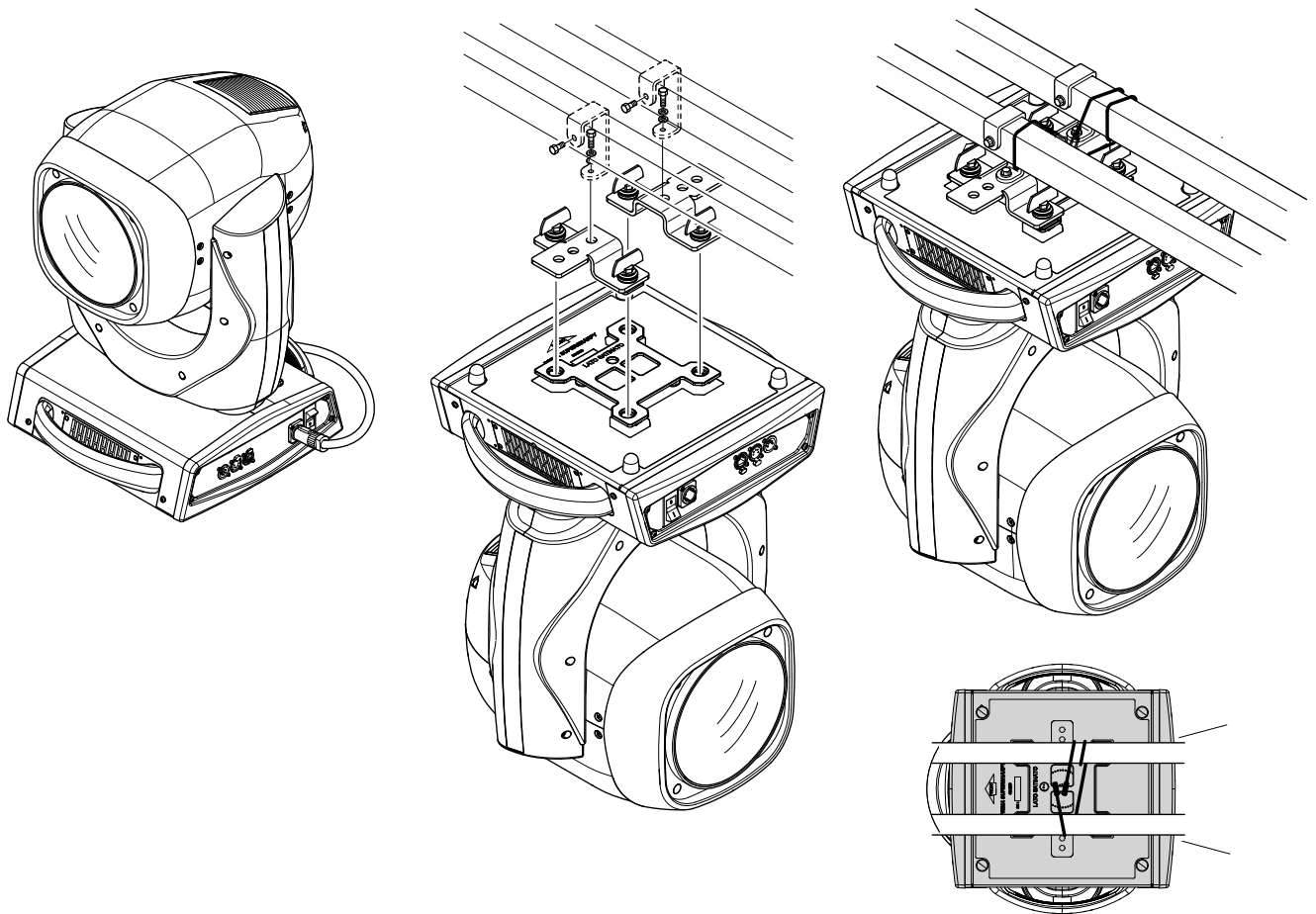

Installing the projector - Fig. 4

The projector can be installed on the floor resting on special rubber feet, on a truss or on the ceiling or wall.

WARNING: *with the exception of when the projector is positioned on the floor, the safety cable must be fitted. (Cod. 105041/003 available on request). This must be securely fixed to the support structure of the projector and then connected to the fixing point at the centre of the base.*



WARNING: light collimation system

This product contains internal light collimation system.
Avoid intense light from any angle.

5

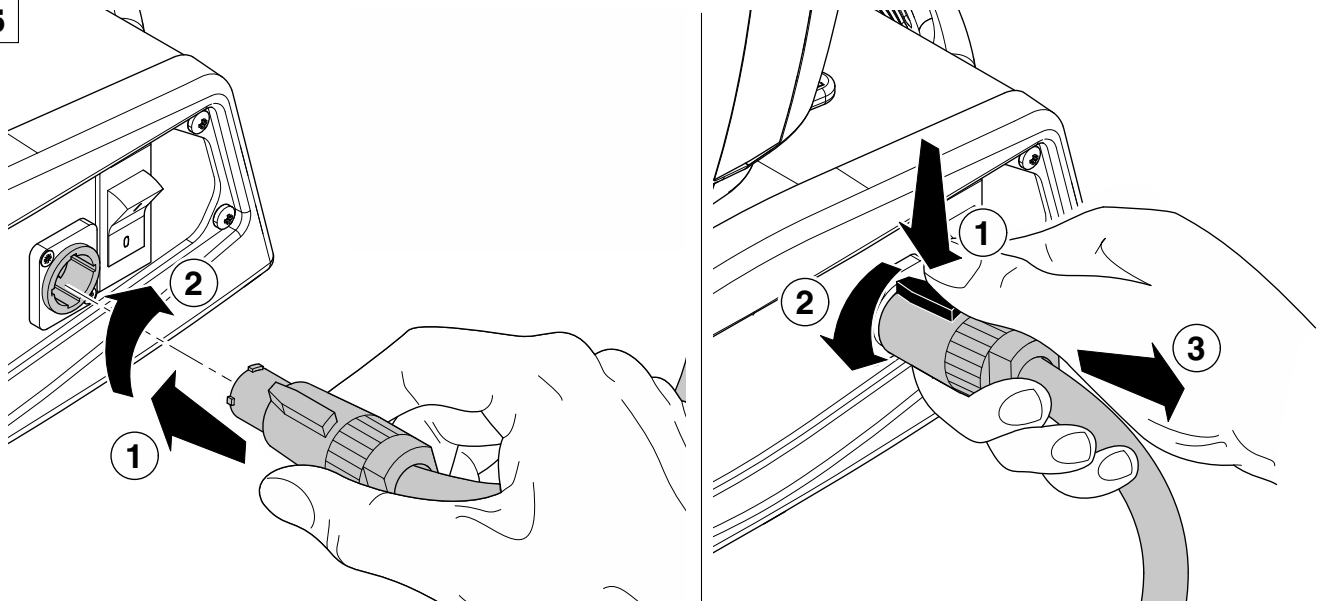

Connecting and disconnecting power cable - Fig. 5

CONTROL PANEL

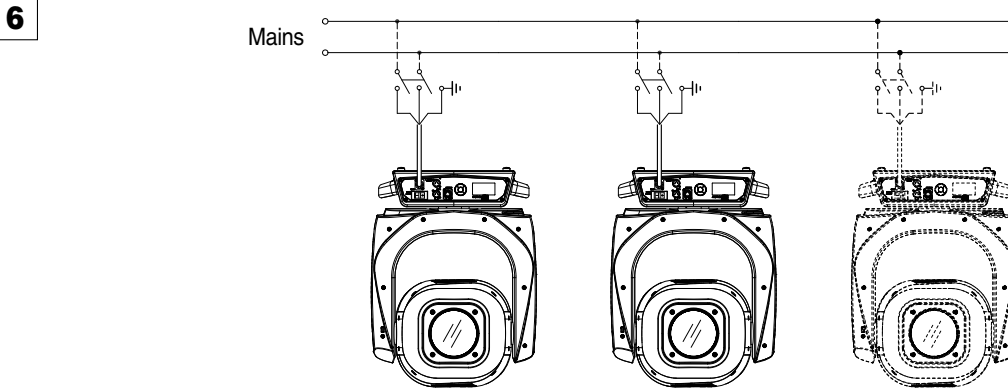

Connecting to the mains supply - Fig. 6

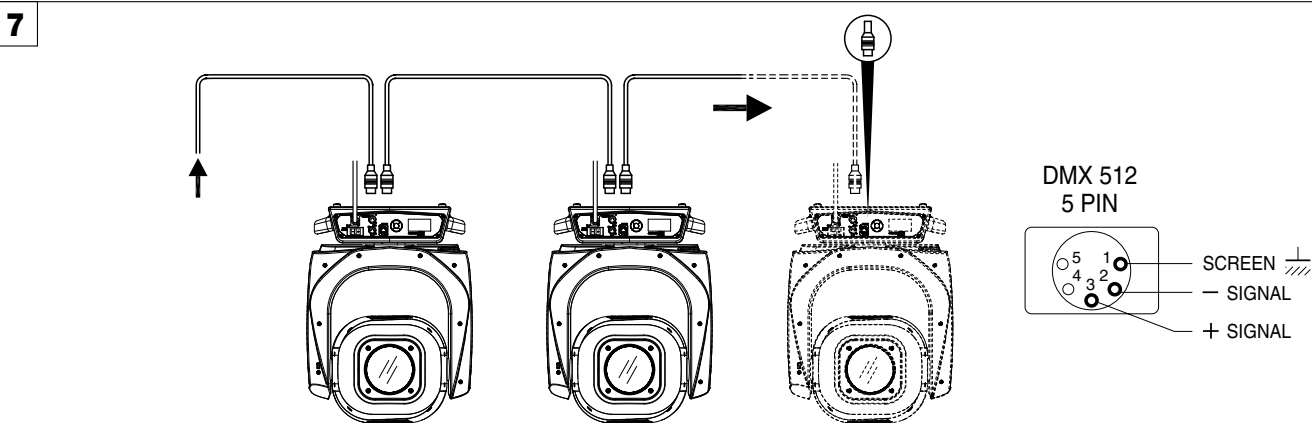

Connecting to the control signal line (DMX) - Fig. 7

Use a cable conforming to specifications EIA RS-485: 2-pole twisted, shielded, 120Ohm characteristic impedance, 22-24 AWG, low capacity. Do not use microphone cable or other cable with characteristics differing from those specified. The end connections must be made using XLR type 5-pin male/female connectors. A terminating plug must be inserted into the last projector with a resistance of 120Ohm (minimum 1/4 W) between terminals 2 and 3.

IMPORTANT: The wires must not make contact with each other or with the metal casing of the connectors. The casing itself must be connected to the shield braid and to pin 1 of the connectors.

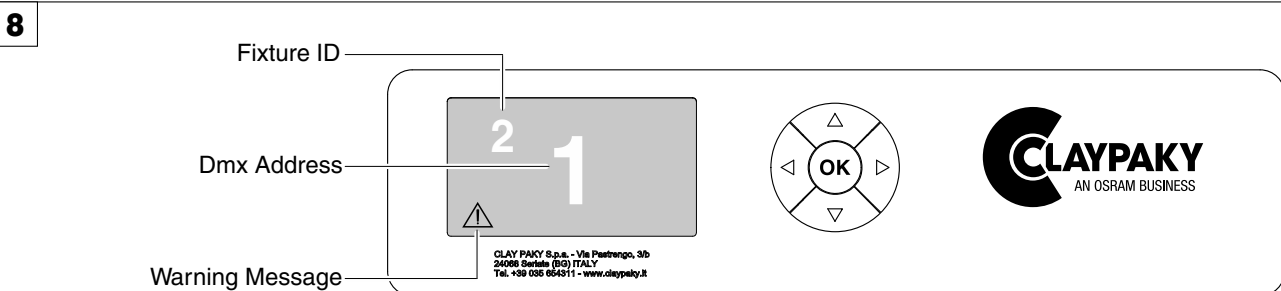

Switching on the projector - Fig. 8

Press the switch. The projector starts resetting the effects. At the same time, the following information scrolls on the display:

	Model HEPIKOS	Firmware Version X.X.X Date - Hour	xxx (Fixture ID) Dmx Address xxx	System errors E: W:
---	-------------------------	---	--	--

On conclusion of resetting in case of absence of the dmX signal, Pan and Tilt move to the "Home" position (Pan 128 bit - Tilt 128 bit). The control panel (Fig. 8) has a display and buttons for the complete programming and management of the projector menu. The display can be in one of two conditions: rest status and setting status. When it is in the rest status, the display shows the projector's DMX address and the Fixture ID address (if set).

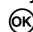
During menu setting status, after a wait time (about 30 seconds) without any key having been pressed, the display automatically returns to rest status. It should be noted that when this condition occurs, any possible value that has been modified but not yet confirmed with the  key will be cancelled.

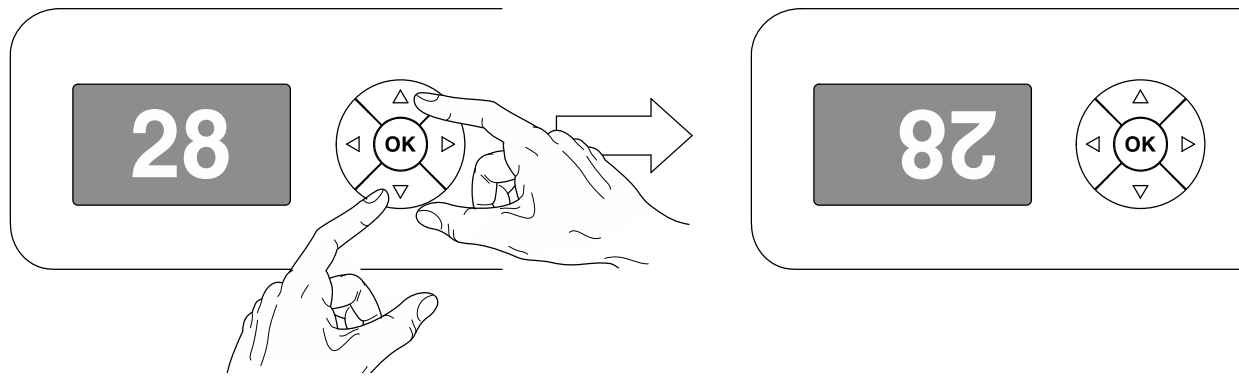

Reversal of the display - Fig. 9

To activate this function, press UP ▲ and DOWN ▼ keys simultaneously while the display is in the rest mode. This status will be memorised and maintained even for the next time it will be switched on. To return to the initial state, repeat the operation all over again.

Setting the projector starting address

On each projector, the starting address must be set for the control signal (addresses from 1 to 512).

The address can also be set with the projector switched off.

Setting the projector Fixture ID

On each projector, the Fixture ID address must be set for an easy identification of the fixtures in an installation (ID from 1 to 255).

The Fixture ID address can be set with the projector switched off.

Functions of the buttons - Using the menu

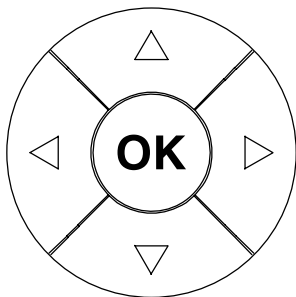

Confirms the displayed value, or activates the displayed function, or enters the successive menu.



DOWN

Decreases the value displayed (with auto-repetitions) or passes to the next item in the menu.



UP

Increases the value displayed (with auto-repetitions) or passes to the previous item in a menu.



LEFT

Return to the top level



RIGHT

Commute from units, tens, hundreds, in the "Address", "Fixture ID" and "Calibration" menu.

USING THE MENU:

- 1) Press **OK** once – "Main Menu" appears on the display.
- 2) Use the UP ▲ and DOWN ▼ keys to select the menu to be used:
 - Setup (Setup Menu): To set the setting options.
 - Option (Option Menu): To set the operating options
 - Informations (Informations Menu): To read the counters, software version and other information.
 - Manual Control (Manual control Menu): To trigger the test and manual control functions.
 - Test (Test Menu): To check the proper functioning of effects
 - Advanced (Advanced Menu): Access to the "Advanced menu" is recommended for a trained technical personnel.
- 3) Press **OK** to display the first item in the selected menu.
- 4) Use the UP ▲ and DOWN ▼ keys to select the MENU items.

Setting addresses and options with the projector disconnected

The projector's DMX address, as well as other possible operating options, can also be set when the appliance is disconnected from the electricity supply. All that is needed is to press **OK** to momentarily activate the display and thus access the settings. Once the required operations have been carried out, the display will switch off again after a wait time of 30 seconds.

10

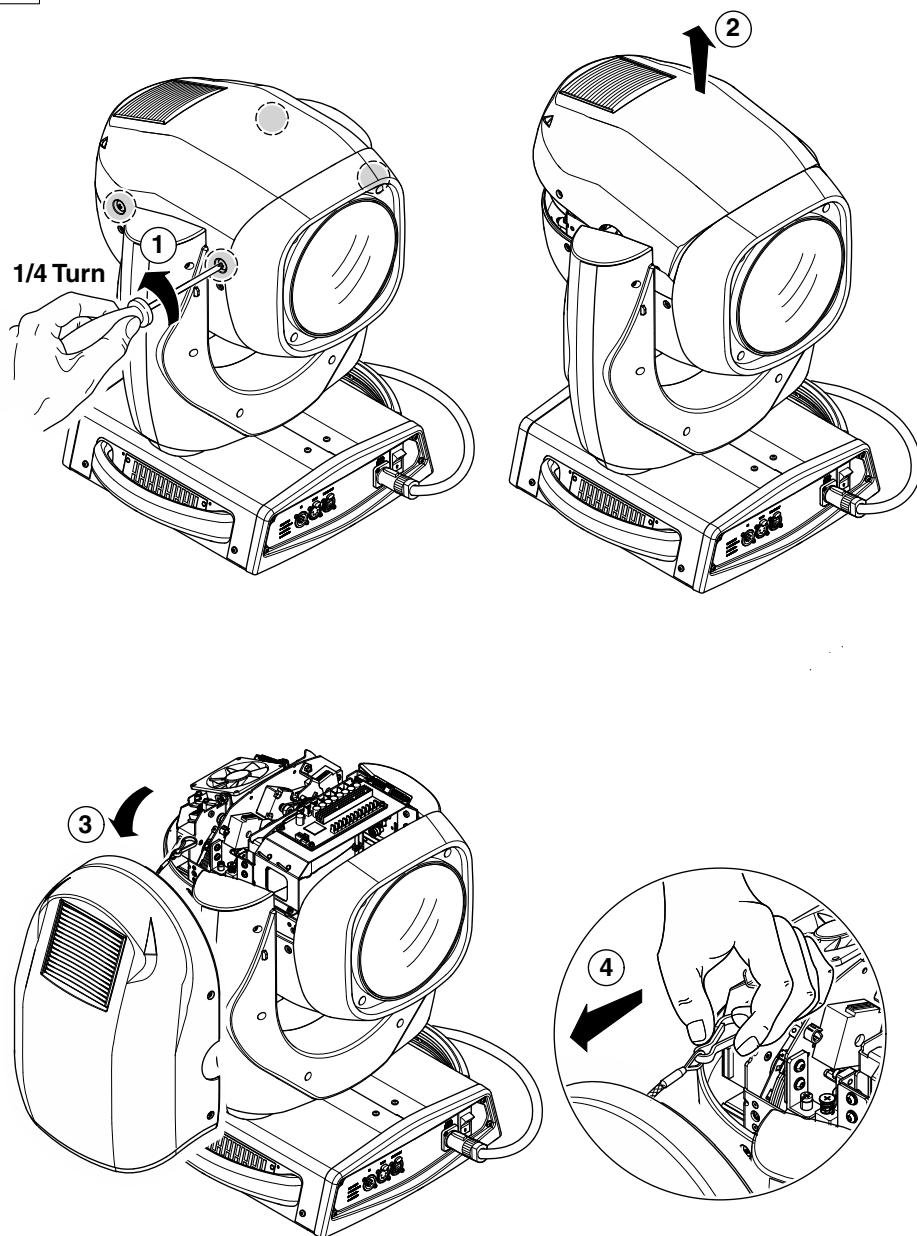

11

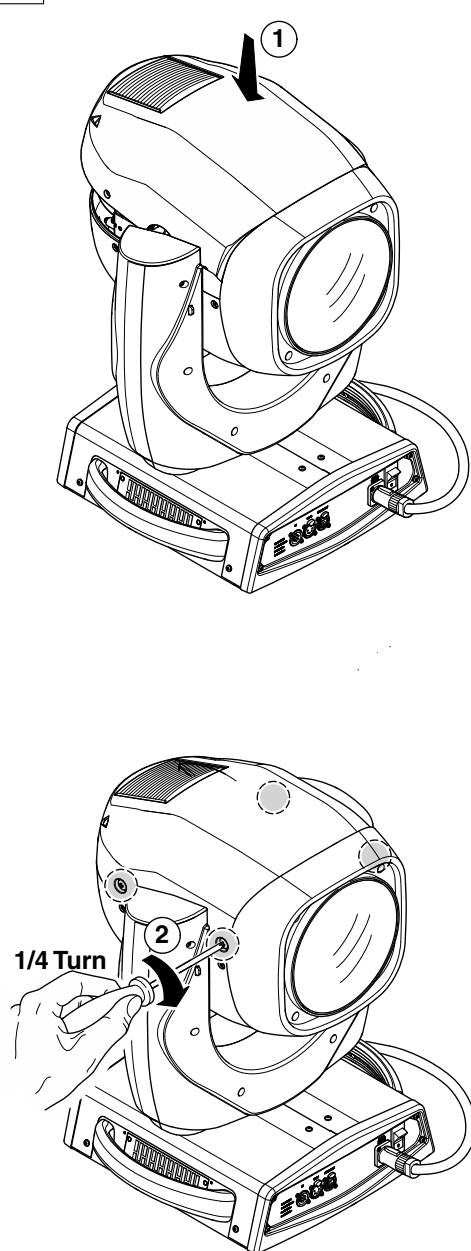

Locking and releasing Pan and Tilt movements - Refer to the instructions in the UNPACKING AND PREPARATION section.

Opening the head covers - Fig. 10.

Closing the head covers - Fig. 11.

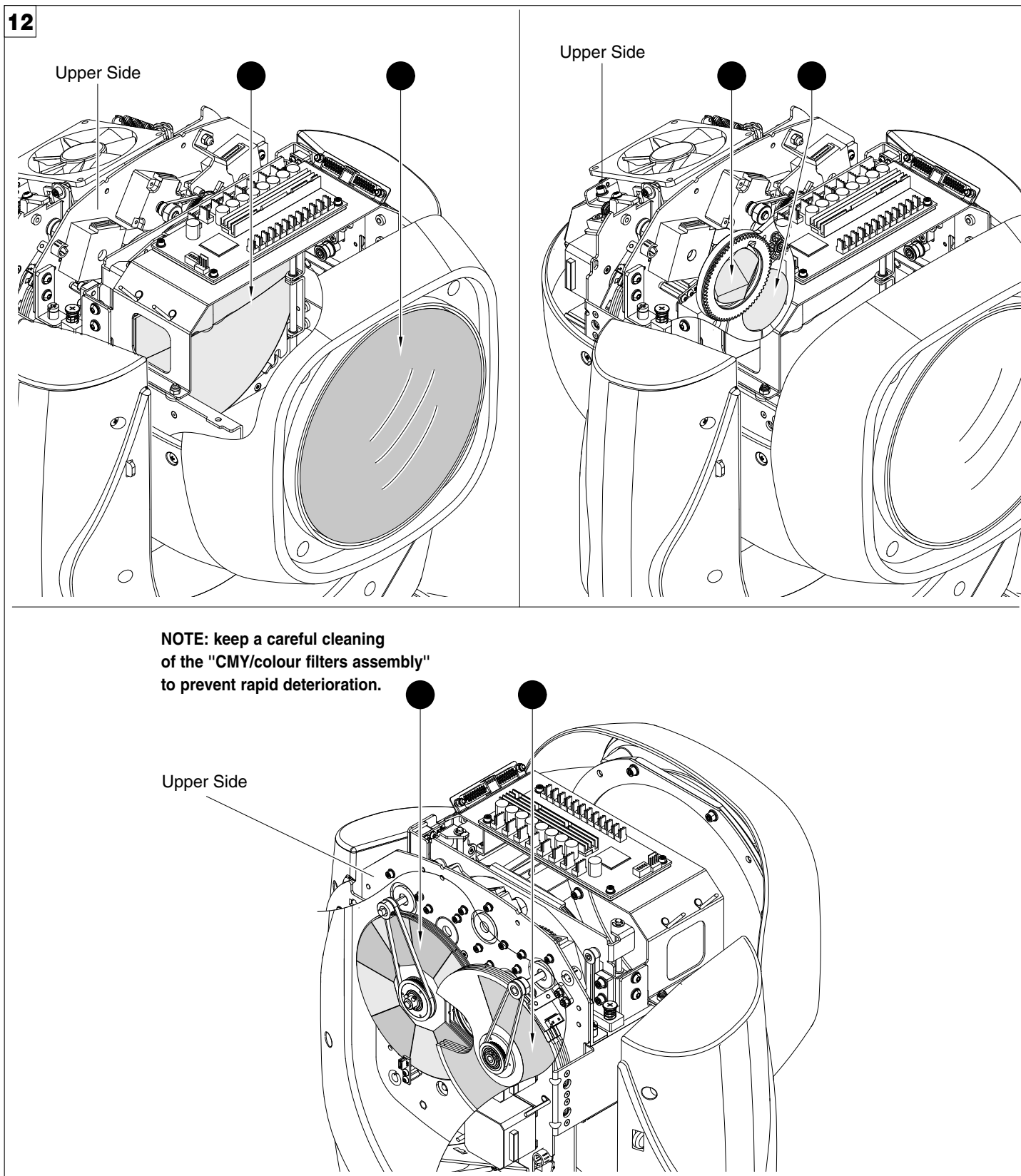

Periodical cleaning - Fig. 12

To ensure optimal operation and performance for a long time it is essential to periodically clean the parts subject to dust and grease deposits. The frequency with which the following operations are to be carried out depends on various factors, such as the amount of the effects and the quality of the working environment (air humidity, presence of dust, salinity, etc.).

Use a soft cloth dampened with any detergent liquid for cleaning glass to remove the dirt from the reflectors, from the lenses and filters. It is recommended that the projector undergoes an annual service by a qualified technician for special maintenance involving at least the following operations:

- General cleaning of internal parts.
- Restoring lubrication of all parts subject to friction, using lubricants specifically supplied by Claypaky.
- General visual check of the internal components, cabling, mechanical parts, etc.
- Electrical, photometric and functional checks; eventual repairs.

NOTE: keep a careful cleaning of the "CMY/colour filters assembly" to prevent rapid deterioration.

13

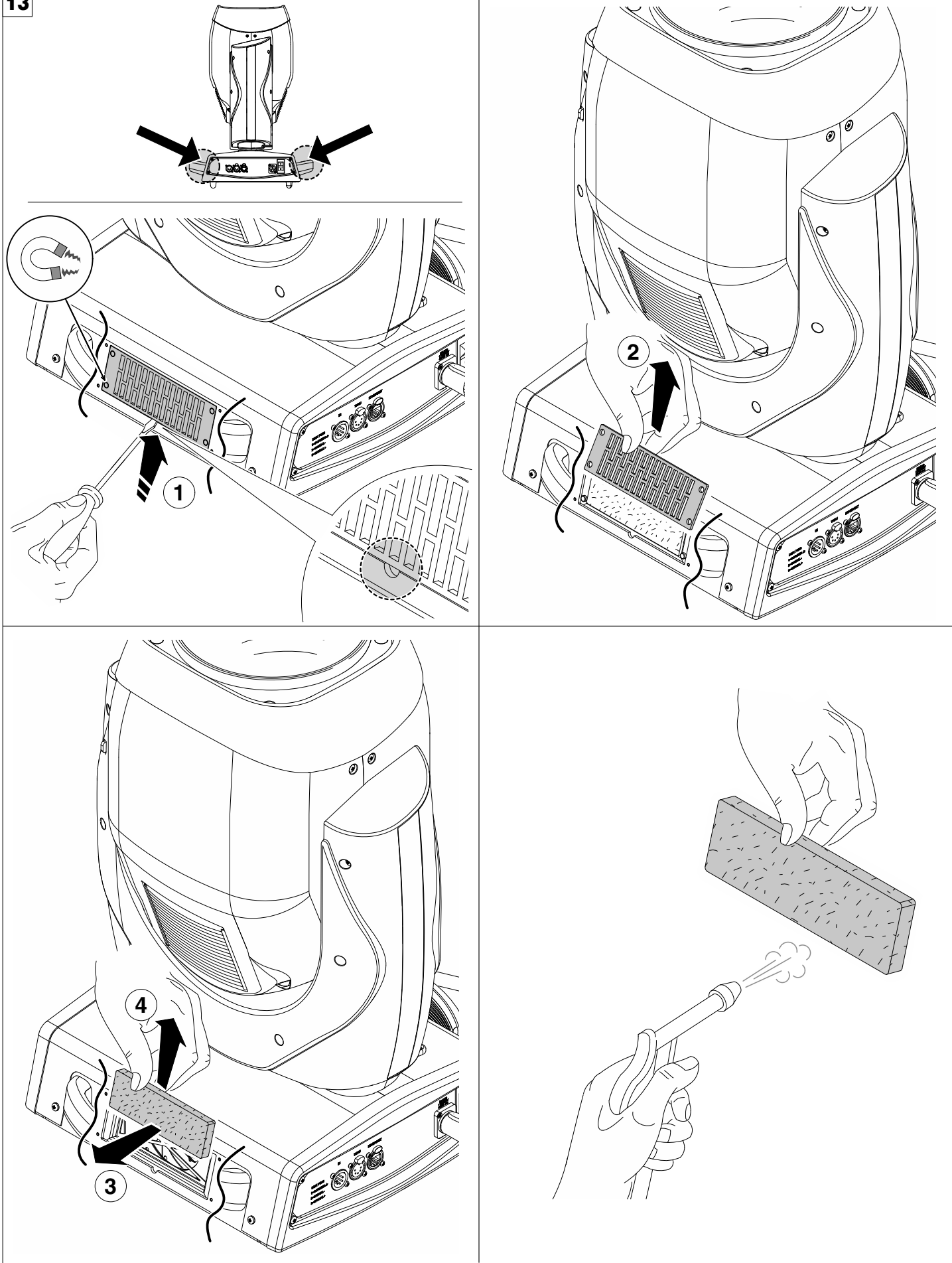

Cleaning of the filters - Fig. 13.

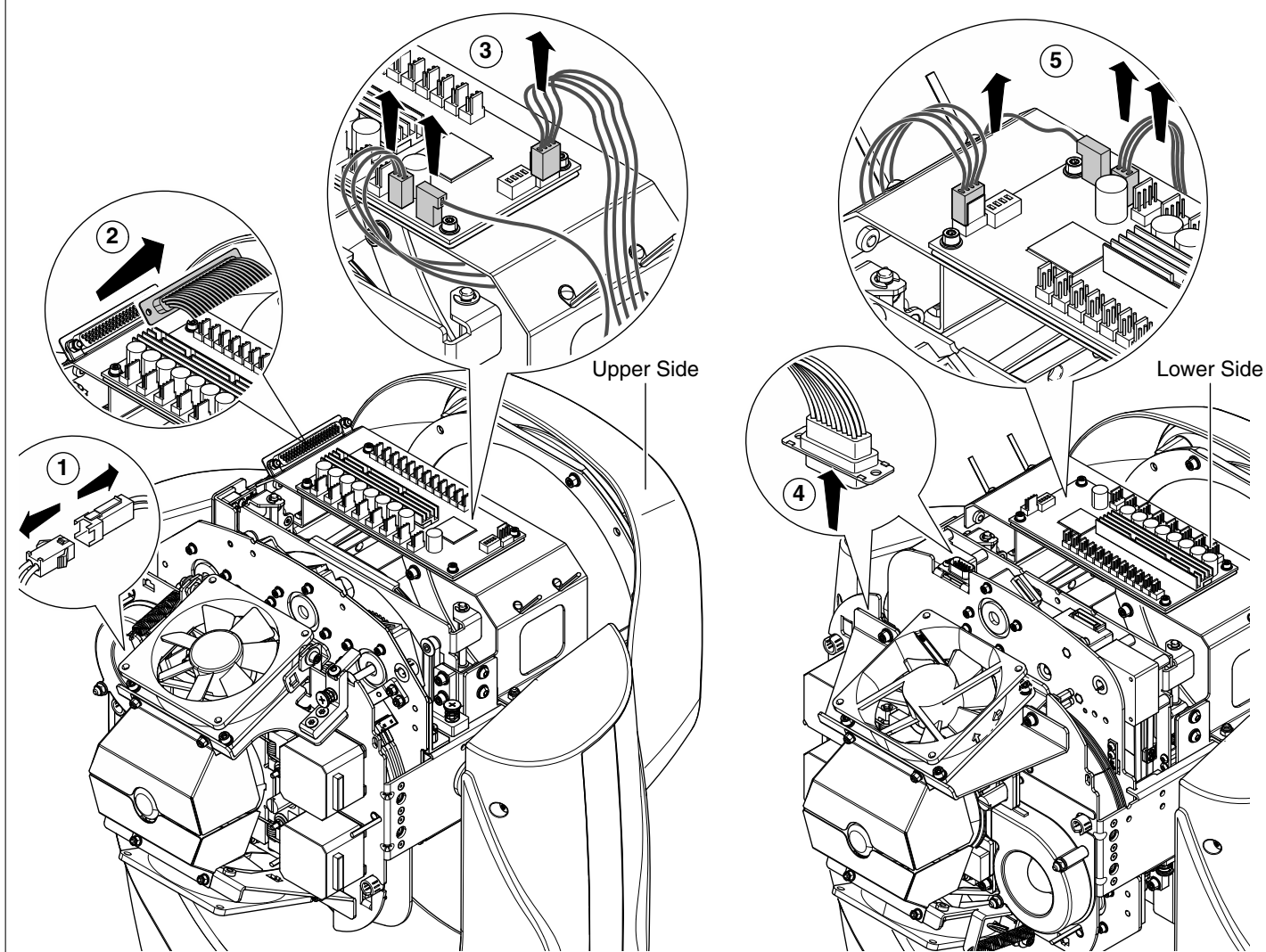
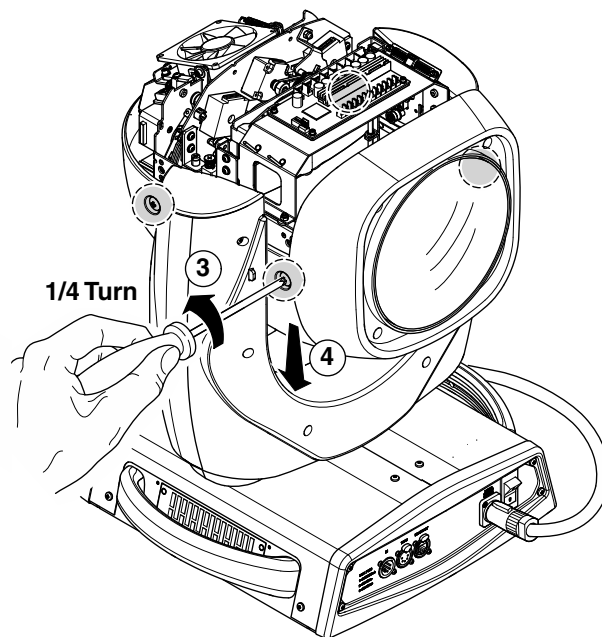
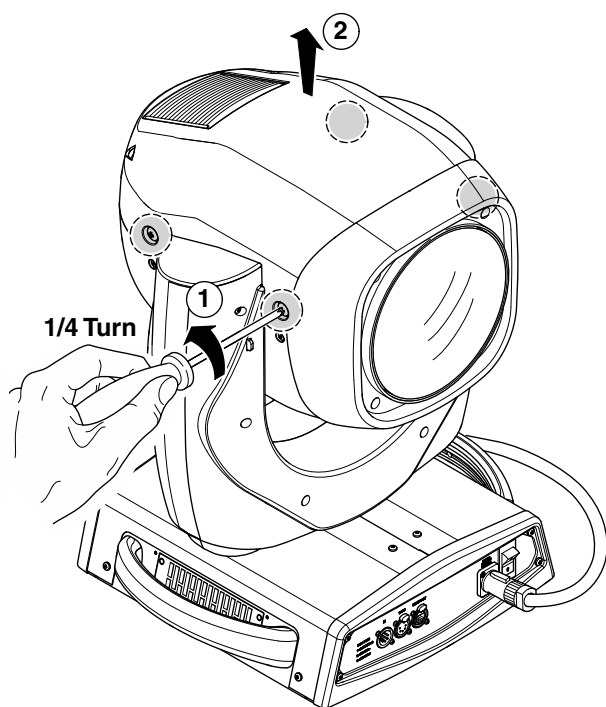

Extraction of the effect modules: Preliminary operations - Fig. 14.

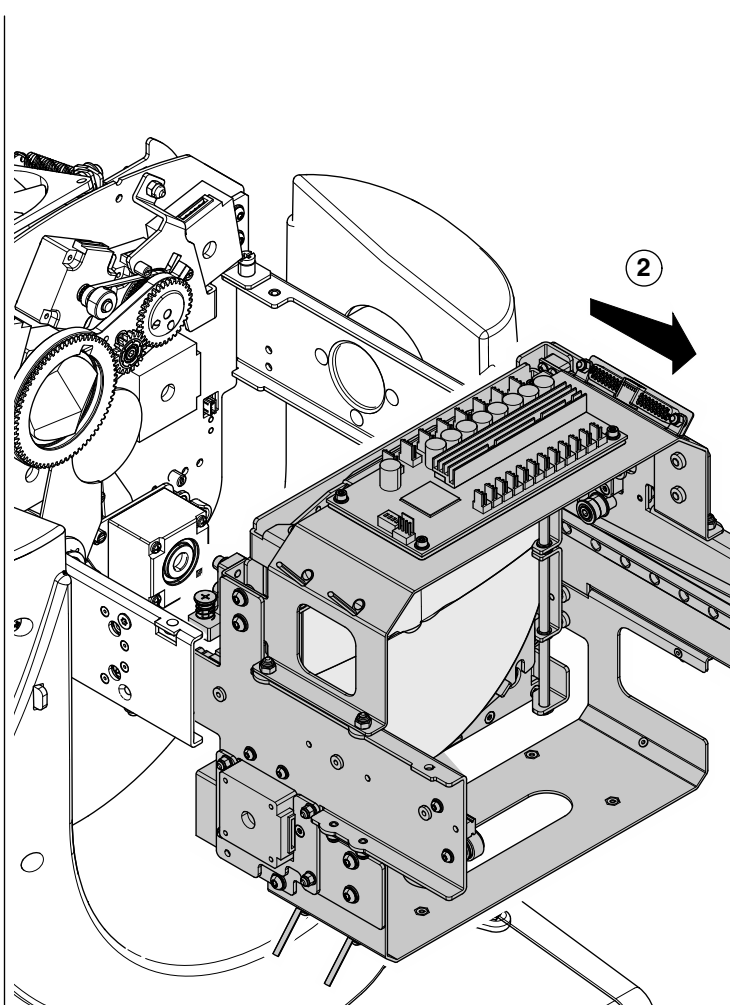
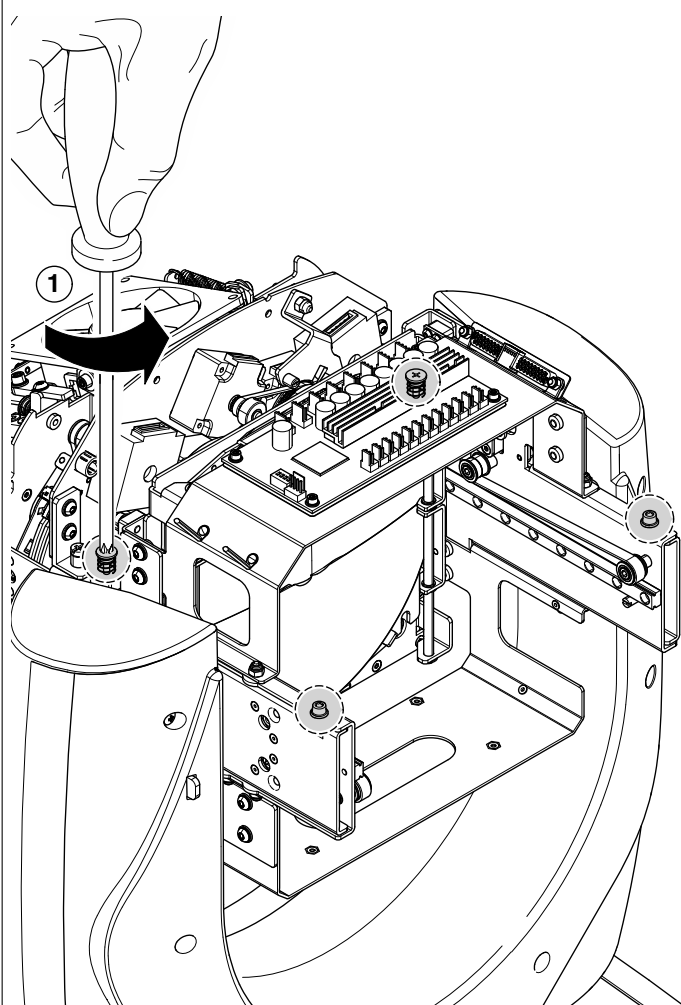
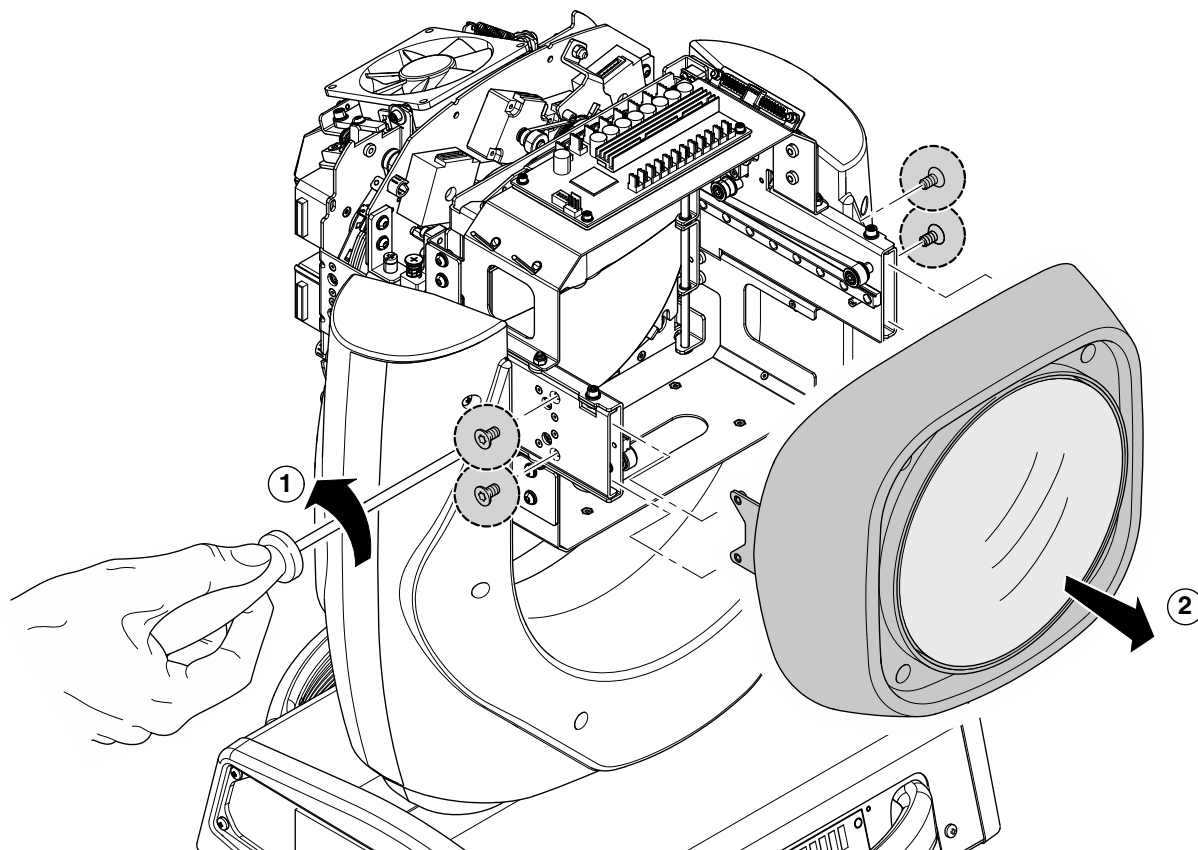

Extraction of the effect modules - Fig. 15.

IMPORTANT: Grasp the modules using the support structure and not the details which could get damaged.

Insertion of the effect modules: Repeat the operations indicated in Fig. 14, 15, and 16 in reverse order.

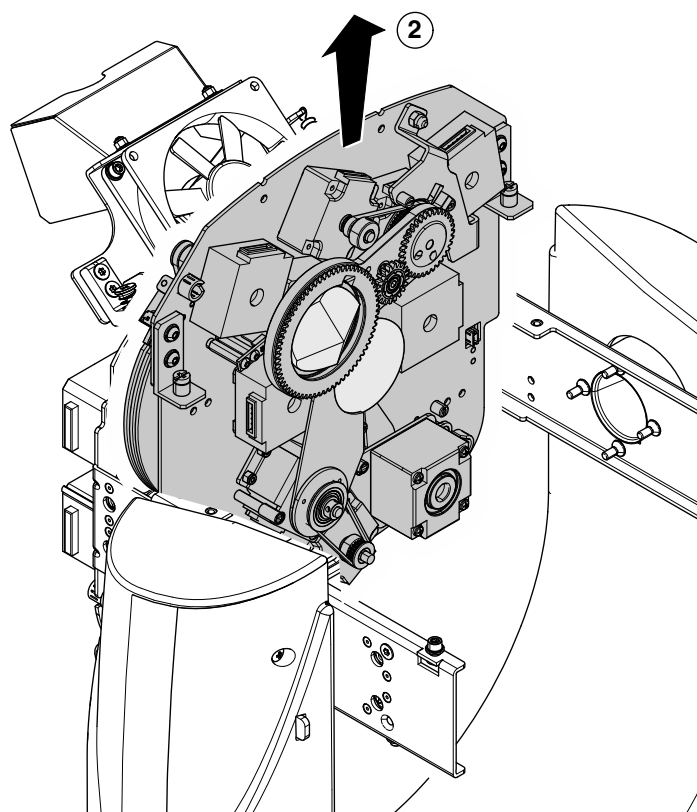
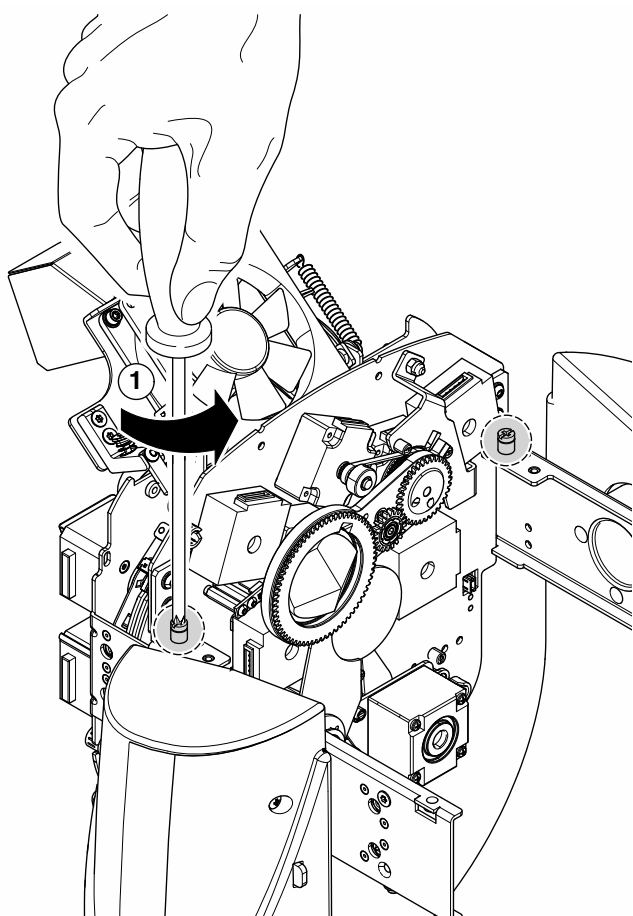
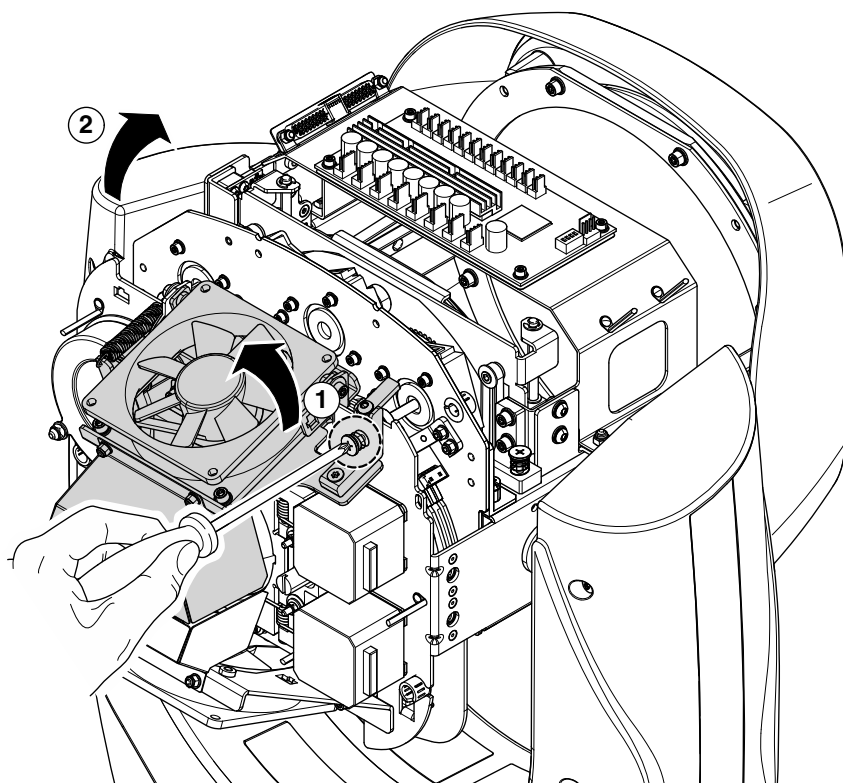

Extraction of the effect modules - Fig. 16.

IMPORTANT: Grasp the modules using the support structure and not the details which could get damaged.

Insertion of the effect modules: Repeat the operations indicated in Fig. 14, 15, and 16 in reverse order.

17

Upper Side

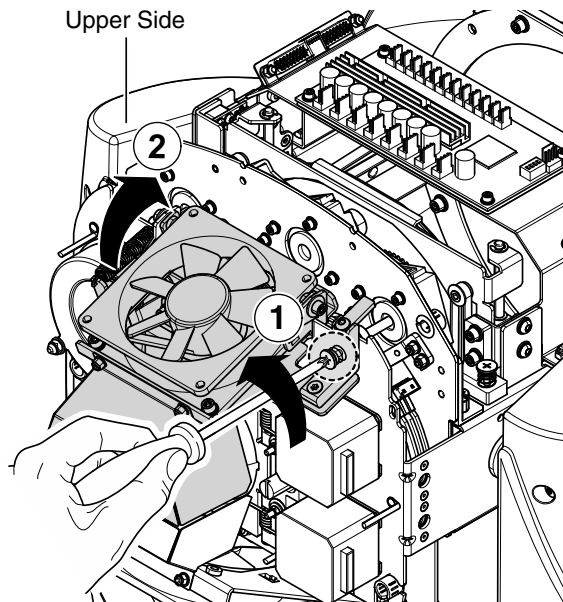

IMPORTANT: Pay attention to the Dimmer blade when you open the lamp department, you can bent it if it is on the wrong position, please move it in the right position (close it) to avoid that.

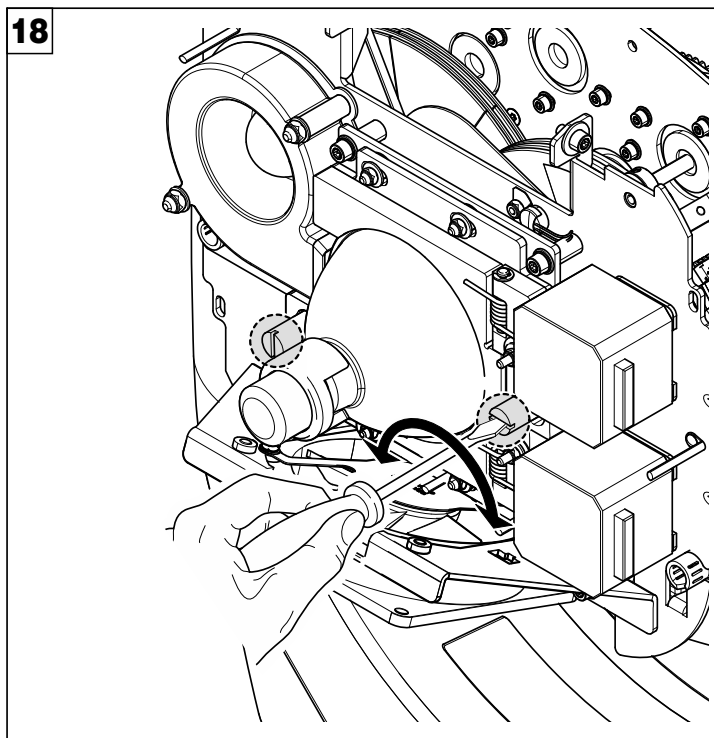
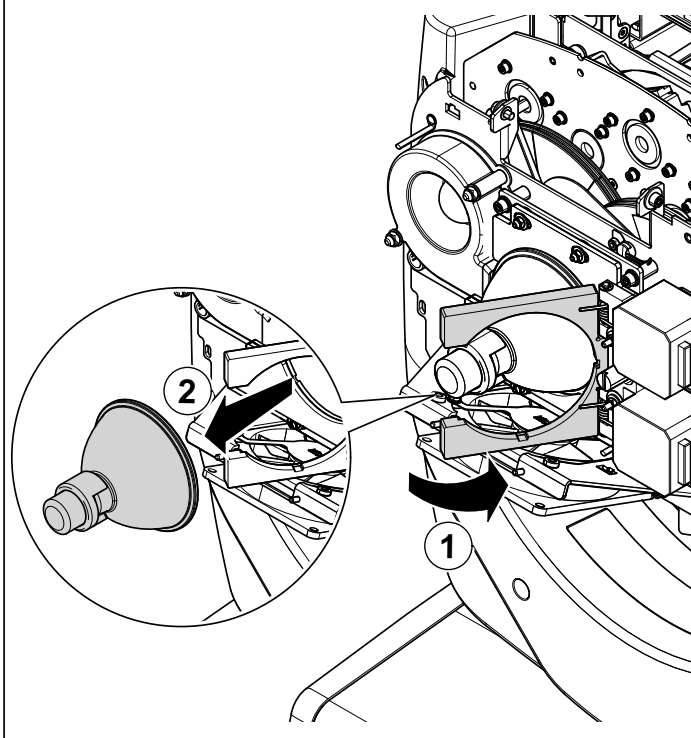
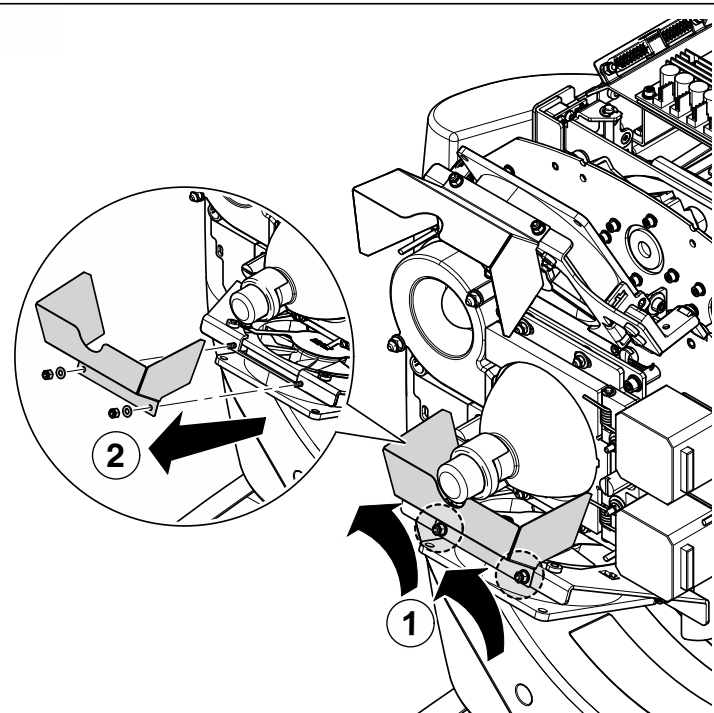

Lamp change - Fig 17

Take the new lamp out of its package and insert in the fitting.

WARNING: do not touch the lamp's envelope with bare hands. Should this happen, clean the bulb with a cloth soaked in alcohol and dry it with a clean, dry cloth.

CAUTION: Fast lamp ON-OFF cycles (for example 10 minutes ON / 10 minutes OFF) will reduce the lamp life.

Lamp regulation - Fig. 18

To centre the lamp, turn the 2 adjusting screws as shown in the figure.

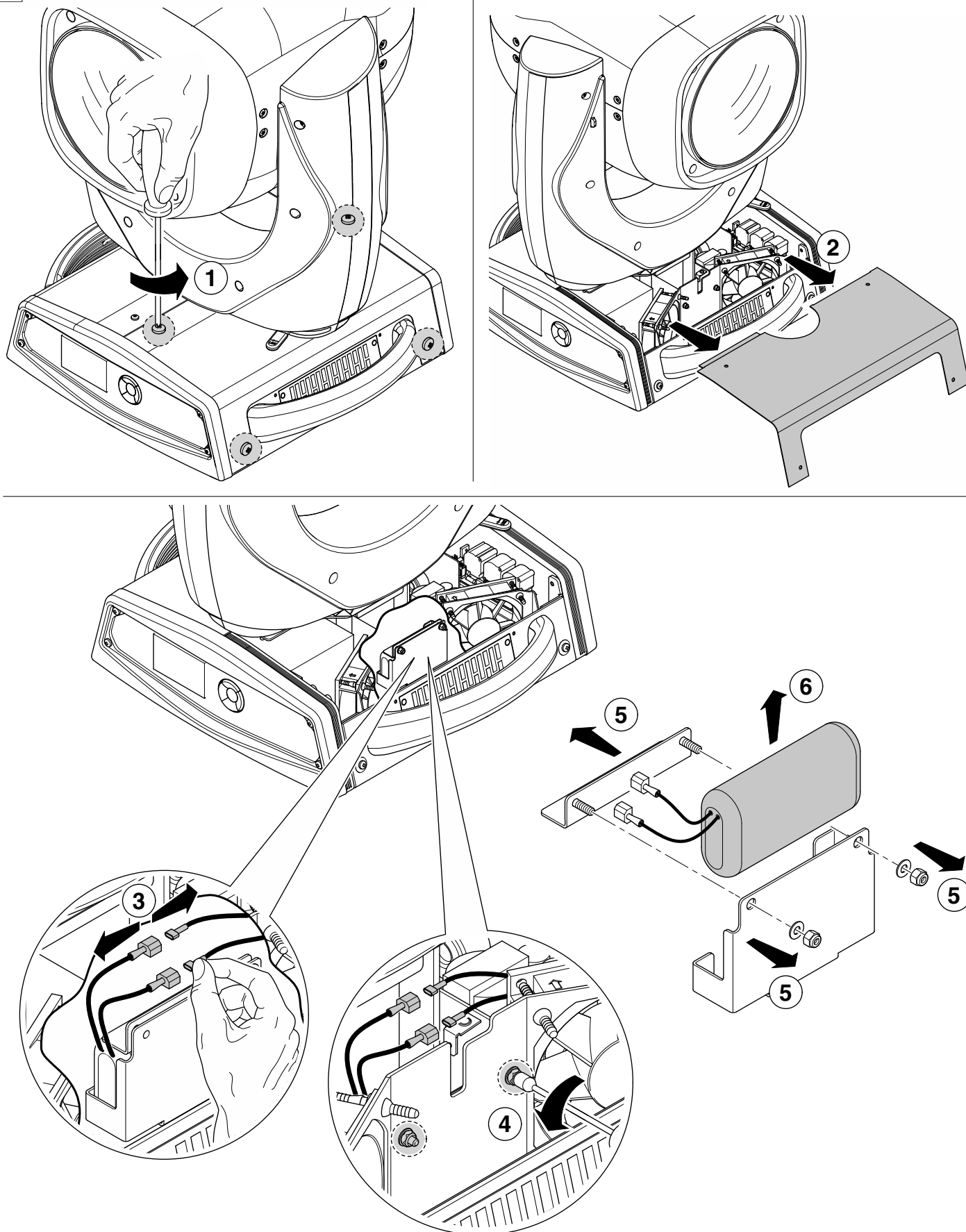

Battery removal - Fig. 19



This product contains a rechargeable battery. To preserve the environment, please dispose the battery at the end of its life according to the regulation in force.

TECHNICAL INFORMATION

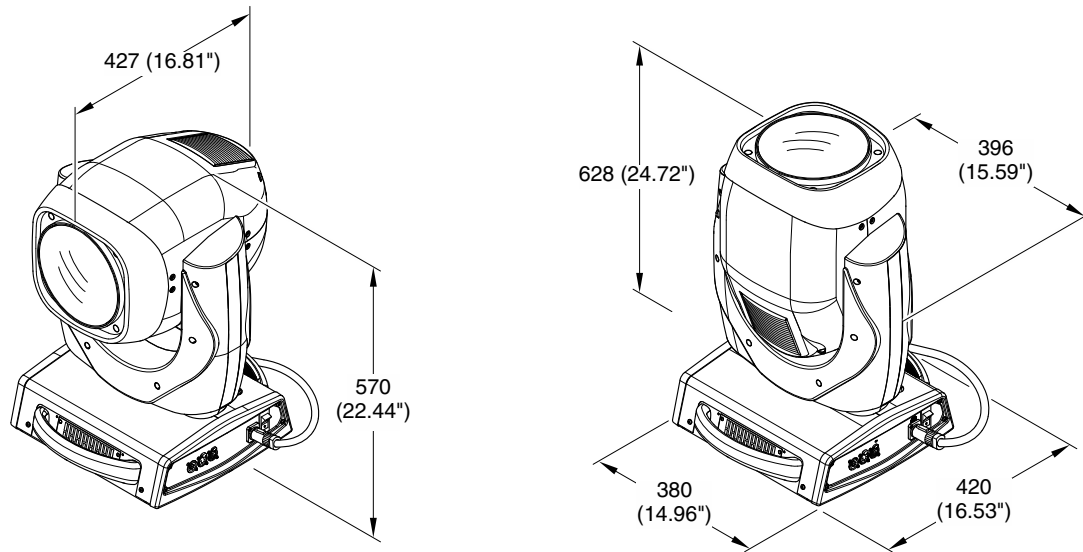

POWER SUPPLIES

AC power input Neutrik PowerCON TRUE1 (IP65) 115/230V 50/60 Hz Automatic power supply switching

INPUT POWER

700 VA @230Vac - 50Hz

LIGHT SOURCE

Osram Sirius HRI 440W H discharge lamp

MOTORS

Stepper motors, operating with micro-steps, totally microprocessor controlled

CHANNELS

20/23 control channels

INPUTS

DMX 512 – Art-Net

NOISE LEVEL

49dBA (Background 33.5dBA)

IP RATING

IP 20 - Protected against the entry of solid bodies larger than 12mm (0.47"); No protection against the entry of liquids.

SAFETY SPECIFICATIONS

Minimum distance of illuminated objects 10 meters
Minimum distance from flammable materials 0.2 meters
Max ambient temperature 40°C (104°F)
Max temperature of the external surface 100°C
Safety devices Bipolar circuit breaker with thermal protection
Automatic break in power supply in case of overheating
Forced ventilation with axial fans

ELECTRONICS

Long life self-charging buffer battery
Function reset from the lighting desk
"AUTOTEST" function from menu
Electronic monitoring with status error
Cooling system monitoring
DMX level monitoring on all channels
Internal data transmission diagnostics
Firmware Upgrade via Web Server / DMX input
Firmware upload from another fixture
Protocols/Functions: RDM, Web Server

OPTICS

Large 185mm diameter PC lens
5°-40° electronic zoom

EFFECTS SECTION

Rotating Prism: 1 x 4-facet prism, indexable on 540°; clockwise and counter-clockwise rotation at variable speed
Variable Frost 0-100% linear
Color system CMY with linear insertion discs
2x Color wheels (8 colors each)
Iris 16-bit, multiple macros (random, pulsing...)
Dimmer 16 bit electronic and linear; 2 dimmer curves
Stop-Strobe 12 flash/sec, electronic, instant open and blackout

CONTROL AND PROGRAMMING

DMX 512 control channels
Control signal USITT DMX 512
Protocols RDM, WebServer and Art-Net
Display Graphic LCD backlit b/w Display
Display battery Long life self-charging buffer battery
Pan/Tilt Resolution 16 bit
Dimmer Resolution 16 bit
Movement control vectorial
DMX signal connection 5 pole XLR input and output
Ethernet Input
Firmware update Software upload through DMX/Ethernet input

BODY

Aluminum and steel structure with plastic covers
Two side handles for transportation Device locking PAN and TILT mechanisms for transportation and maintenance

MOVING BODY

PAN range 540°
TILT range 244°

WORKING POSITION

Working in any position Hanging system: with fast-lock omega clamps (1/4 turn) on the base

CE MARKING

In conformity with the European Directives:

- 2014/35/EU - Safety of electrical equipment supplied at low voltage (LVD)
- 2014/30/EU - Electromagnetic Compatibility (EMC)
- 2011/65/EU - Restriction of the use of certain hazardous substances (RoHS)
- 2009/125/EC - EcoDesign requirements for Energy-related Products (ErP)

WEIGHT & DIMENSIONS

28.9 Kg

CAUSE AND SOLUTION OF PROBLEMS

THE PROJECTOR WILL NOT SWITCH ON					PROBLEMS
ELECTRONICS NON-OPERATIONAL					
DEFECTIVE PROJECTION					
REDUCED LUMINOSITY					
POSSIBLE CAUSES				CHECKS AND REMEDIES	
●			No mains supply.	Check the power supply voltage.	
●		●	Lamp exhausted or defective.	Replace the lamp. (See instructions).	
	●		Signal transmission cable faulty or disconnected.	Replace the cables.	
	●		Incorrect addressing.	Check addresses (see instructions).	
	●		Fault in the electronic circuits.	Call an authorised technician.	
	●		Lenses or reflector broken	Call an authorised technician.	
		● ●	Dust or grease deposited.	Clean (see instructions).	