

INSTRUCTION MANUAL

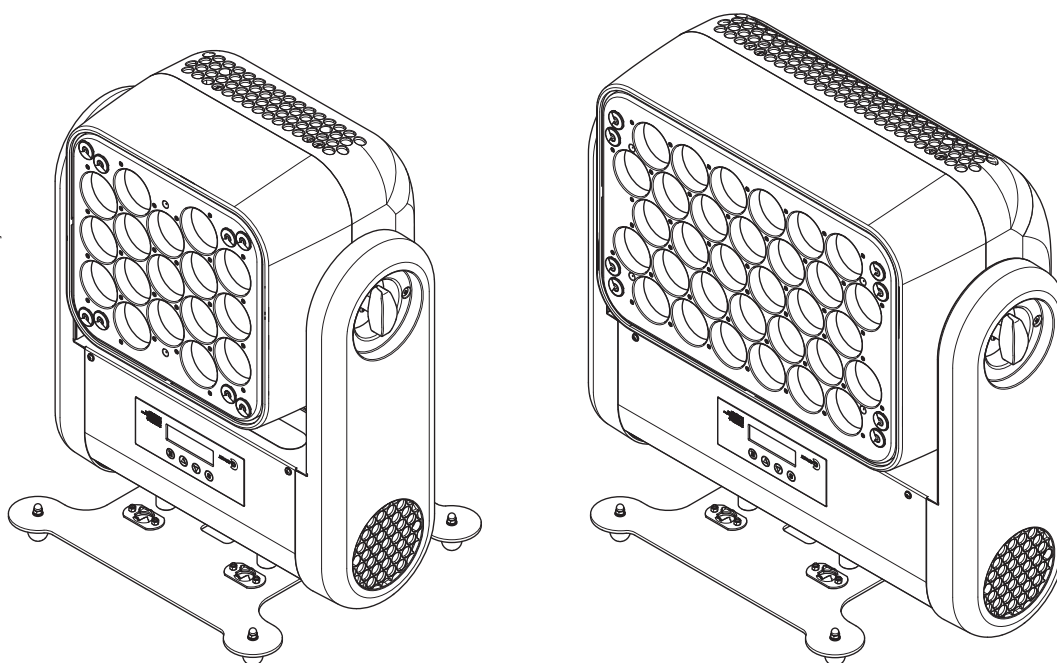

INDEX

Page	Contents
2	Safety information
3	Unpacking and preparation
4	Installation and start-up
5	Control panel
8	Maintenance
11	Technical information

*Congratulations on choosing a Claypaky product!
We thank you for your custom.*

Please note that this product, as all the others in the rich Claypaky range, has been designed and made with total quality to ensure excellent performance and best meet your expectations and requirements.

SAFETY INFORMATION

EN

SAFETY INFORMATION

IMPORTANT: Claypaky recommends you carefully read and keep the safety information on this product, also available in digital format at the following link:

www.claypaky.com

Ref: [FIS016 - Safety Information A.leda K-EYE series]

IT

INFORMAZIONI DI SICUREZZA

IMPORTANTE: Claypaky raccomanda di leggere accuratamente e conservare le informazioni di sicurezza relative a questo prodotto, sempre reperibili in versione digitale al seguente link:

www.claypaky.com

Rif: [FIS016 - Safety Information A.leda K-EYE series]

DE

INFORMATIONEN ZUR SICHERHEIT

WICHTIG: Claypaky empfiehlt, die Sicherheitsinformationen bezüglich dieses Produkts genau zu lesen und aufzubewahren. Sie sind in Digitalversion immer unter folgendem Link auffindbar:

www.claypaky.com

Ref: [FIS016 - Safety Information A.leda K-EYE series]

ES

INFORMACIONES DE SEGURIDAD

IMPORTANTE: Claypaky recomienda leer detenidamente y conservar la información de seguridad relativa a este producto. Además, está disponible una versión digital de la misma en el siguiente enlace:

www.claypaky.com

Ref: [FIS016 - Safety Information A.leda K-EYE series]

FR

CONSIGNES DE SÉCURITÉ

IMPORTANT: Claypaky recommande de lire attentivement et de conserver les informations de sécurité relatives à ce produit, disponibles en version digitale au lien suivant:

www.claypaky.com

Réf. : [FIS016 - Safety Information A.leda K-EYE series]

RU

ИНСТРУКЦИЮ ПО ТЕХНИКЕ БЕЗОПАСНОСТИ

ВАЖНО: Claypaky рекомендует внимательно прочитать и сохранить инструкцию по технике безопасности данного изделия, которая всегда доступна в электронном формате по следующей ссылке:

www.claypaky.com

Наименование: [FIS016 - Safety Information A.leda K-EYE series]

UNPACKING AND PREPARATION

1

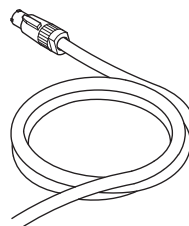
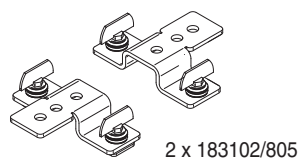

Packing contents - Fig. 1

2

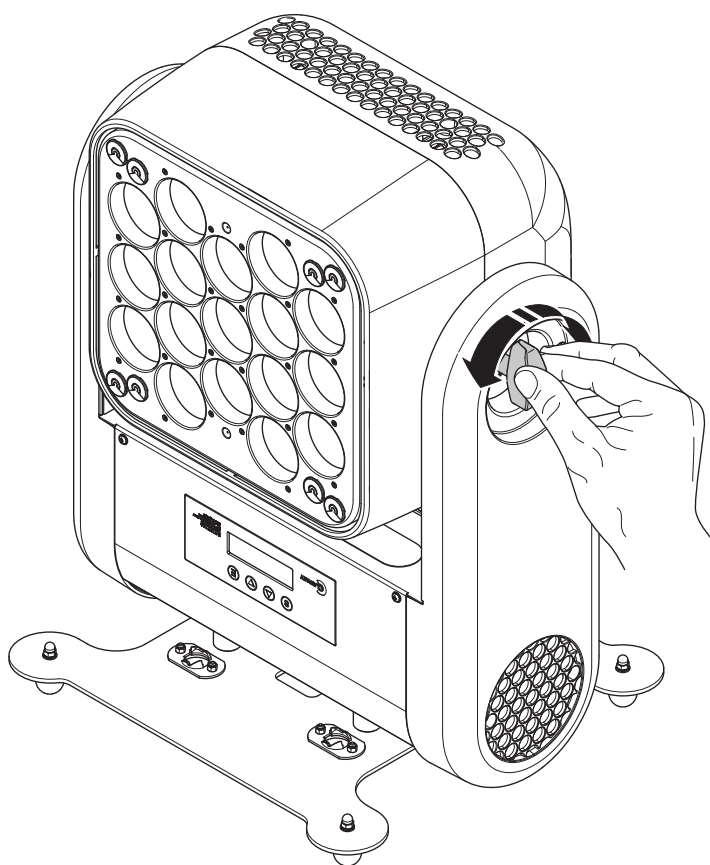

Head tilt adjustment - Fig. 2

3

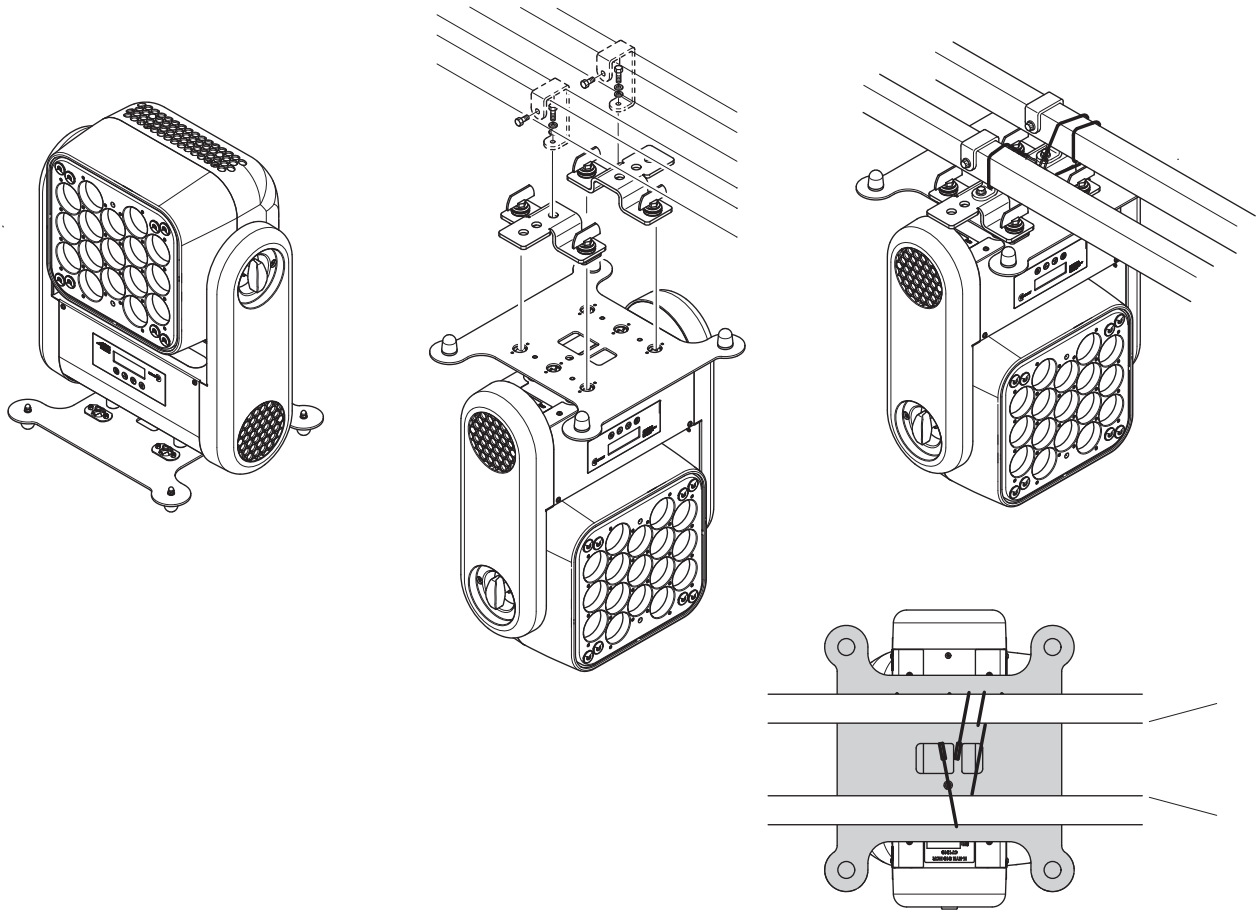

Installing the projector - Fig. 3

The projector can be installed on the floor resting on special rubber feet, on a truss or on the ceiling or wall.

WARNING: with the exception of when the projector is positioned on the floor, the safety cable must be fitted. (Cod. 105041/003 available on request). This must be securely fixed to the support structure of the projector and then connected to the fixing point at the centre of the base.

4

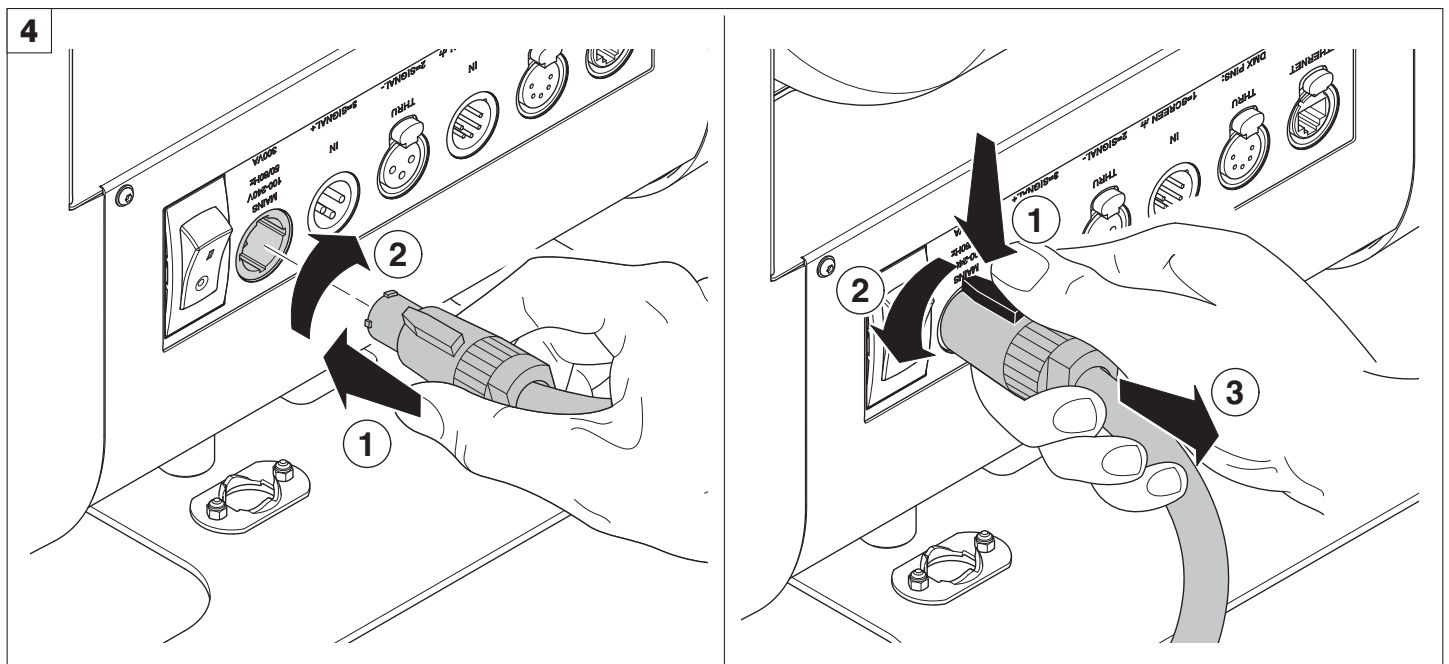

Connecting and disconnecting power cable - Fig. 4

CONTROL PANEL

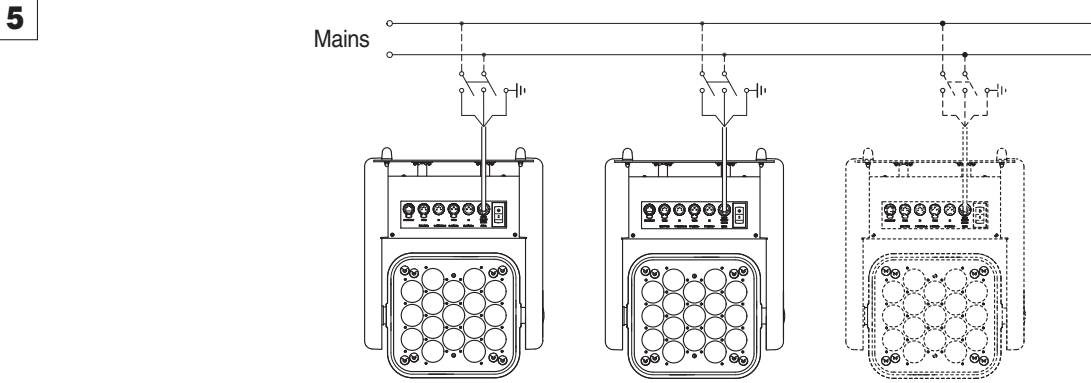

Connecting to the mains supply - Fig. 5

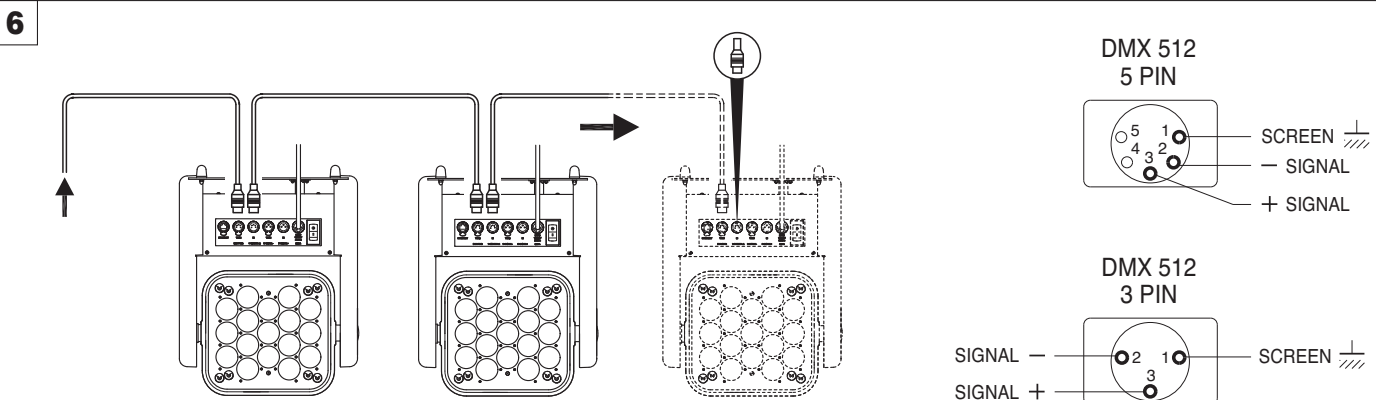

Connecting to the control signal line (DMX) - Fig. 6

Use a cable conforming to specifications EIA RS-485: 2-pole twisted, shielded, 120Ohm characteristic impedance, 22-24 AWG, low capacity. Do not use microphone cable or other cable with characteristics differing from those specified. The end connections must be made using XLR type 3/5-pin male/female connectors. A terminating plug must be inserted into the last projector with a resistance of 120Ohm (minimum 1/4 W) between terminals 2 and 3.

IMPORTANT: The wires must not make contact with each other or with the metal casing of the connectors. The casing itself must be connected to the shield braid and to pin 1 of the connectors.

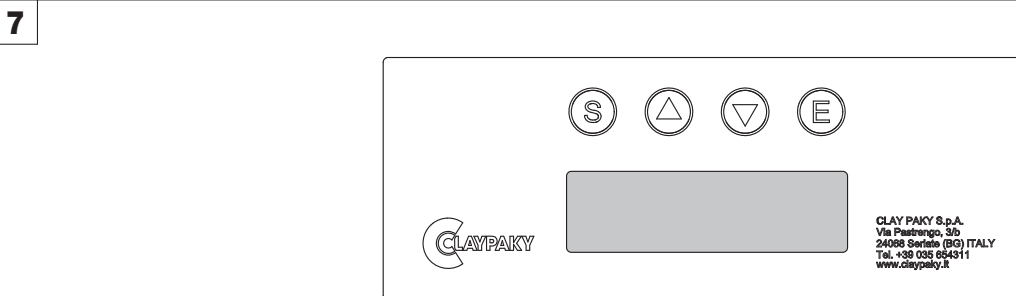

Switching on the projector - Fig. 7

Press the switch. The projector starts resetting the effects. At the same time, the following information scrolls on the display:

	Model K-Eye S10&S20 HCR	Firmware Version X.X.X Date - Hour	xxx (Fixture ID) Dmx Address xxx	System errors E: W:
---	-------------------------------	--	-------------------------------------	---------------------------------------

The control panel (Fig. 7) has a display and buttons for the complete programming and management of the projector menu.

The display can be in one of two conditions: rest status and setting status. When it is in the rest status, the display shows the projector's DMX address and the Fixture ID address (if set).

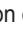
During menu setting status, after a wait time (about 30 seconds) without any key having been pressed, the display automatically returns to rest status. It should be noted that when this condition occurs, any possible value that has been modified but not yet confirmed with the  key will be cancelled.

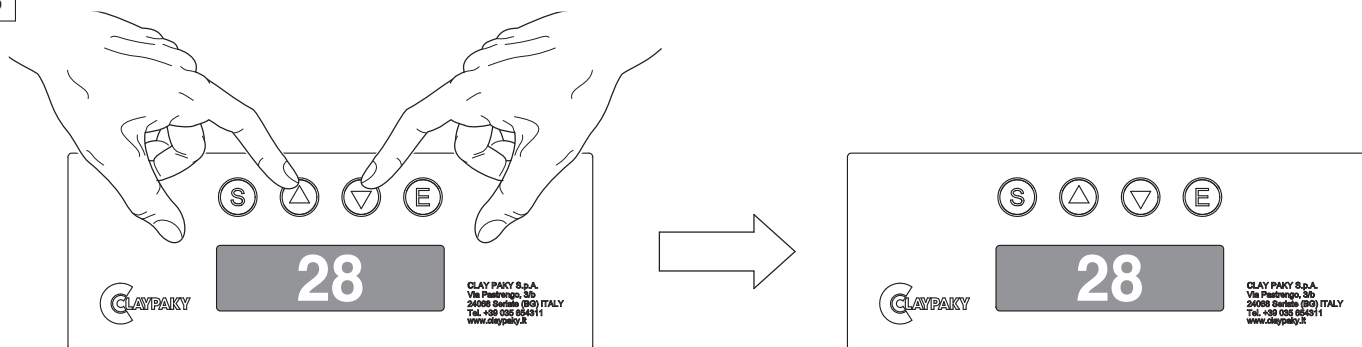

Reversal of the display - Fig. 8

To activate this function, press UP (triangle up) and DOWN (triangle down) keys simultaneously while the display is in the rest mode. This status will be memorised and maintained even for the next time it will be switched on. To return to the initial state, repeat the operation all over again.

Setting the projector starting address

On each projector, the starting address must be set for the control signal (addresses from 1 to 512).

The address can also be set with the projector switched off.

Setting the projector Fixture ID

On each projector, the Fixture ID address must be set for an easy identification of the fixtures in an installation (ID from 1 to 255).

The Fixture ID address can be set with the projector switched off.

Functions of the buttons - Using the menu

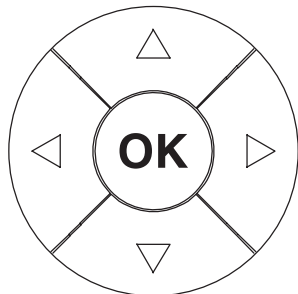

Confirms the displayed value, or activates the displayed function, or enters the successive menu.



DOWN

Decreases the value displayed (with auto-repetitions) or passes to the next item in the menu.



UP

Increases the value displayed (with auto-repetitions) or passes to the previous item in a menu.



LEFT

Return to the top level.



RIGHT

Commute from units, tens, hundreds, in the "Address", "Fixture ID" and "Calibration" menu.

USING THE MENU:

- 1) Press **OK** once – "Main Menu" appears on the display.
- 2) Use the UP (triangle up) and DOWN (triangle down) keys to select the menu to be used:
 - Setup (Setup Menu): To set the setting options.
 - Option (Option Menu): To set the operating options
 - Informations (Informations Menu): To read the counters, software version and other information.
 - Manual Control (Manual control Menu): To trigger the test and manual control functions.
 - Test (Test Menu): To check the proper functioning of effects
 - Advanced (Advanced Menu): Access to the "Advanced menu" is recommended for a trained technical personnel.
- 3) Press **OK** to display the first item in the selected menu.
- 4) Use the UP (triangle up) and DOWN (triangle down) keys to select the MENU items.

Setting addresses and options with the projector disconnected

The projector's DMX address, as well as other possible operating options, can also be set when the appliance is disconnected from the electricity supply. All that is needed is to press **OK** to momentarily activate the display and thus access the settings. Once the required operations have been carried out, the display will switch off again after a wait time of 30 seconds.



Light collimation system

This product contains internal light collimation system. Avoid intense light from any angle.

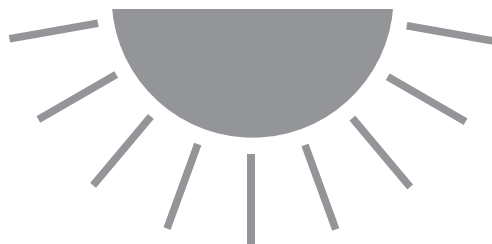

WARNING:
no alcohol

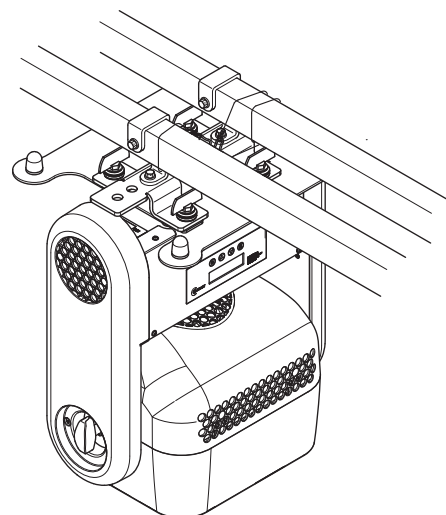
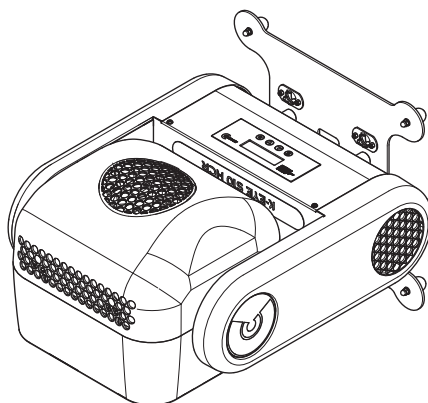
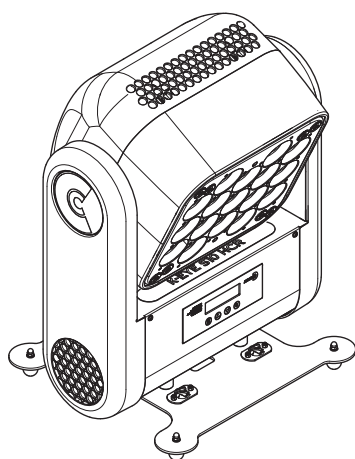
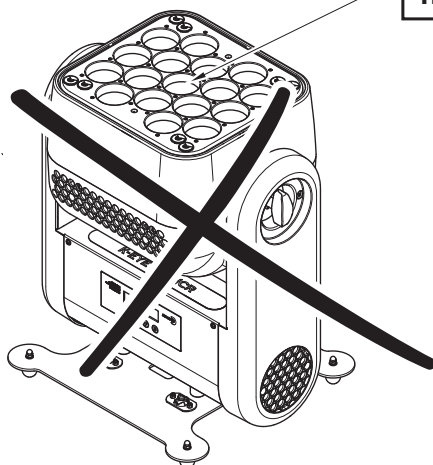

CAUTION:

- To avoid damage to the internal parts of the fixture when the fixture is not working, is recommended to turn the head down before turning the fixture off, so that the front lenses of the fixture are invested as little as possible from the sun.
- Set Zoom channel to 255-bit before turning off the projector to facilitate the packaging of the projector.
- It is recommended not to use compressed air with more than 4 atmospheres for cleaning the internal parts of the fixture, led board area. This is to avoid damaging electronic components.
- To ensure optimal operation and performance for a long time it is essential to periodically clean the parts subject to dust and grease deposits. The frequency with which the following operations are to be carried out depends on various factors, such as the amount of the effects and the quality of the working environment (air humidity, presence of dust, salinity, etc.).
It is recommended that the projector undergoes an annual service by a qualified technician for special maintenance involving at least the following operations:
 - General cleaning of internal parts.
 - Restoring lubrication of all parts subject to friction, using lubricants specifically supplied by Claypaky.
 - General visual check of the internal components, cabling, mechanical parts, etc.
 - Electrical, photometric and functional checks; eventual repairs.

Cleaning the lenses

Only use neutral soap and water to clean the lenses, then dry it carefully with a soft, non-abrasive cloth. (WARNING: the use of alcohol or any other detergent could damage the lenses).

10

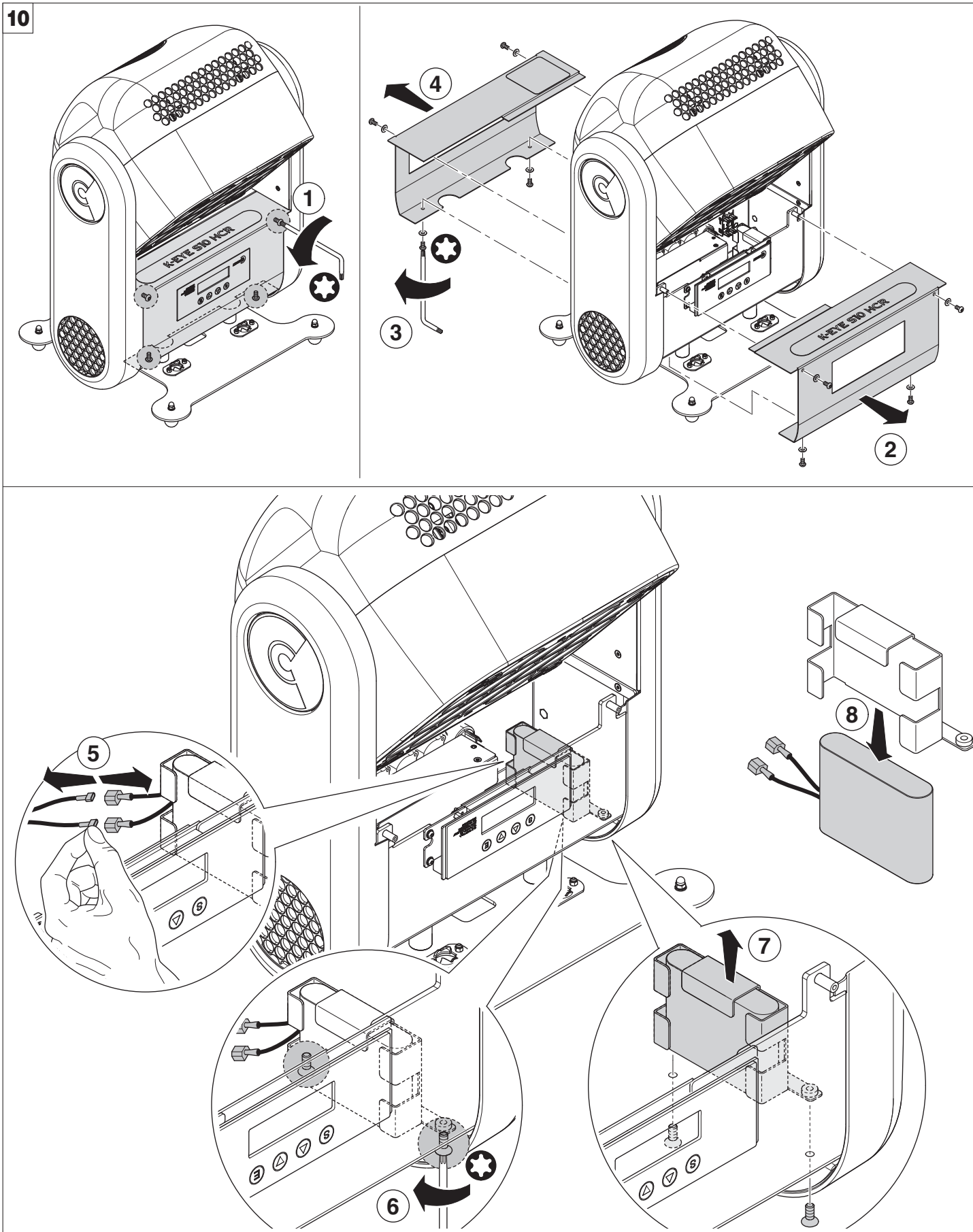

Battery removal - Fig. 10



This product contains a rechargeable battery. To preserve the environment, please dispose the battery at the end of its life according to the regulation in force.

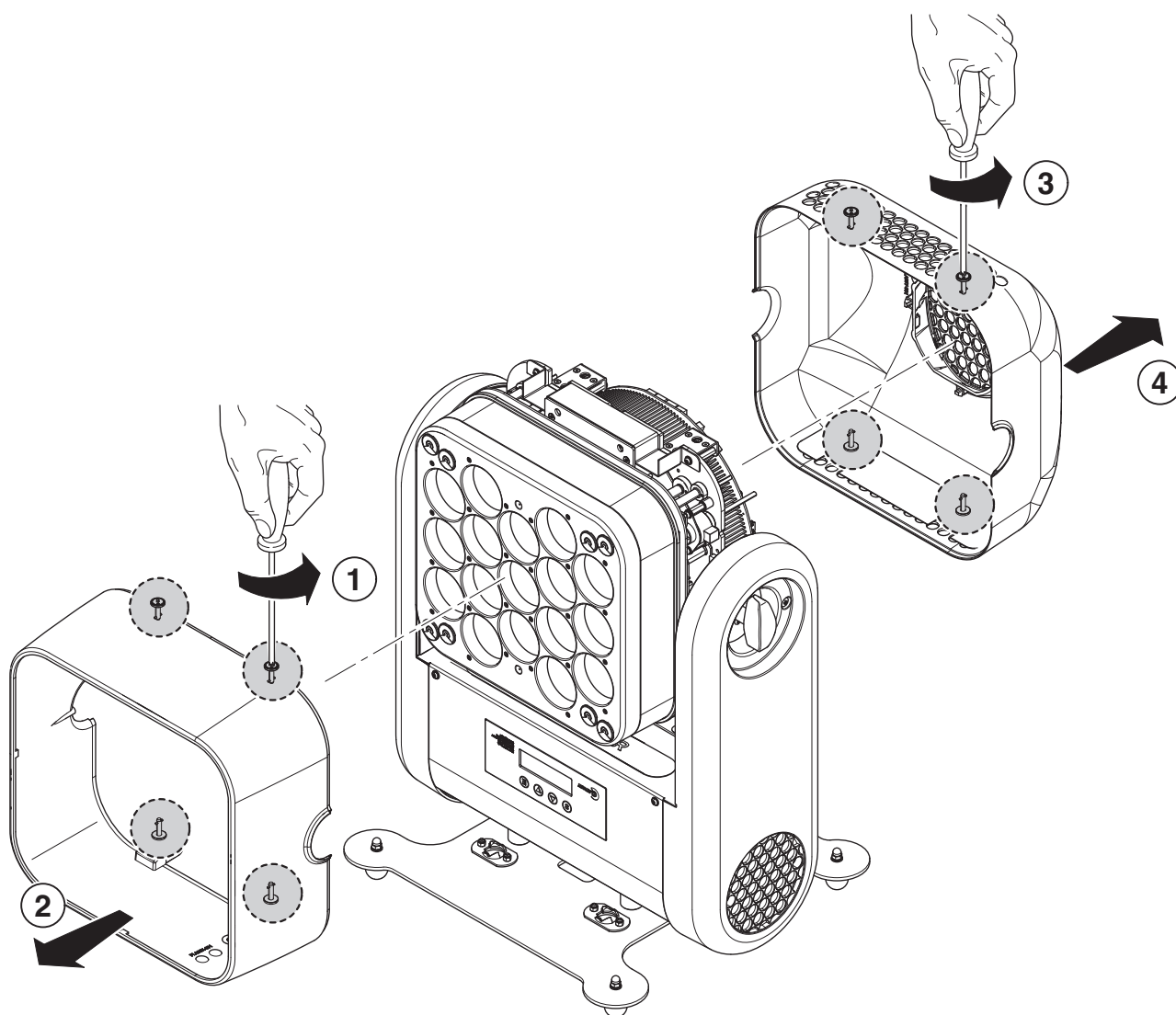

Opening the covers - Fig. 11

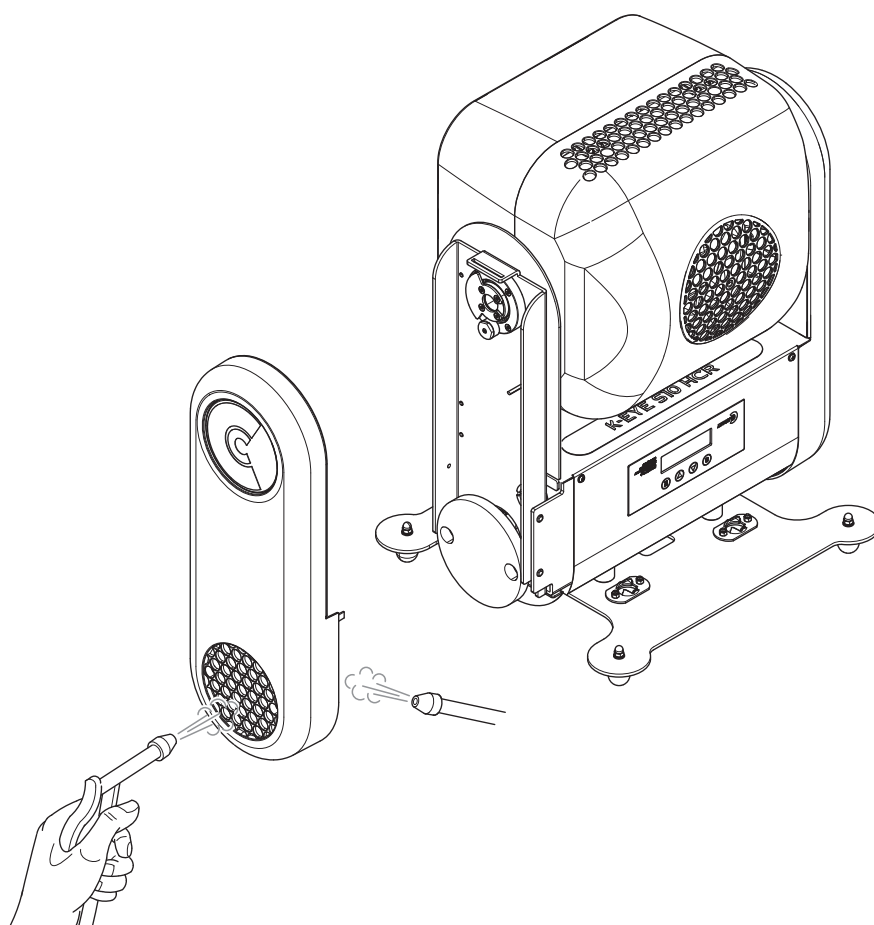
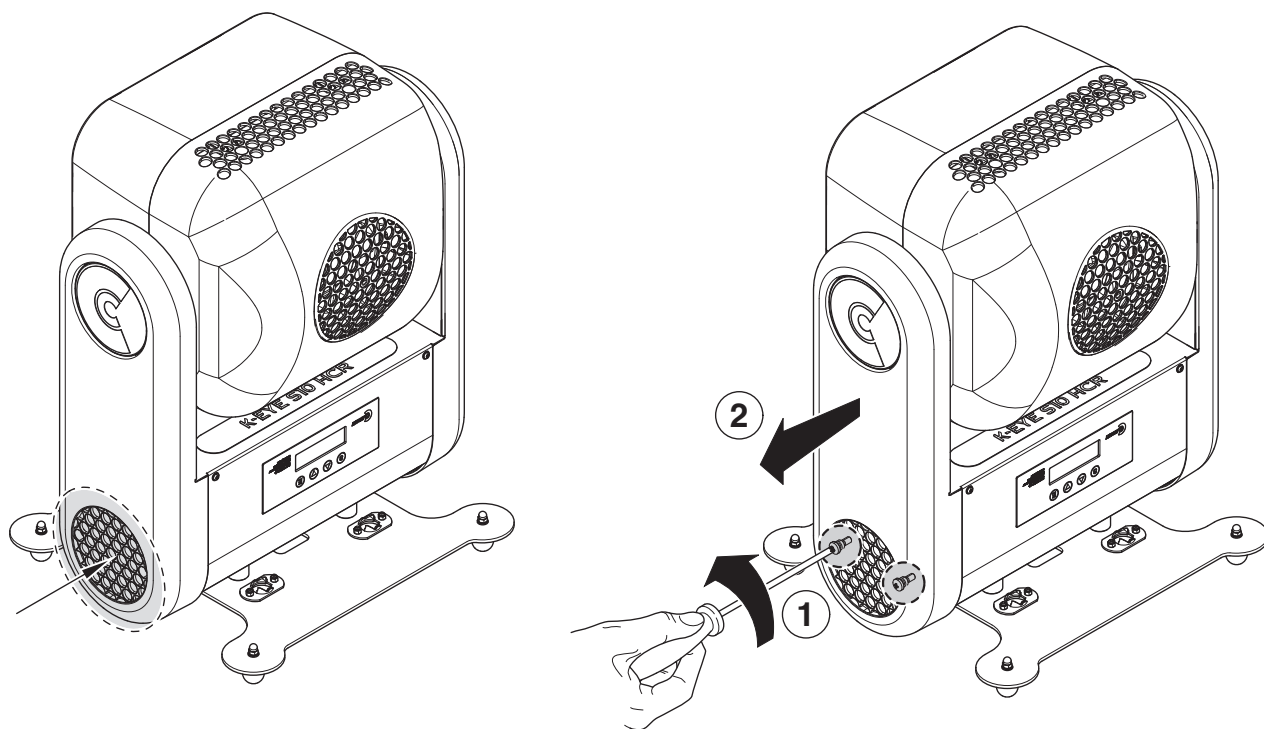

Cleaning of the filters - Fig. 12

CAUSE AND SOLUTION OF PROBLEMS

THE PROJECTOR WILL NOT SWITCH ON				PROBLEMS
ELECTRONICS NON-OPERATIONAL				
DEFECTIVE PROJECTION				
REDUCED LUMINOSITY				
POSSIBLE CAUSES				CHECKS AND REMEDIES
●			No mains supply.	Check the power supply voltage.
●		●	LED exhausted or defective.	Call an authorised technician.
	●		Signal transmission cable faulty or disconnected.	Replace the cables.
	●		Incorrect addressing.	Check addresses (see instructions).
	●		Fault in the electronic circuits.	Call an authorised technician.
	●		Lenses broken	Call an authorised technician.
	●	●	Dust or grease deposited.	Clean (see instructions).

TECHNICAL INFORMATION

K-EYE S10 HCR

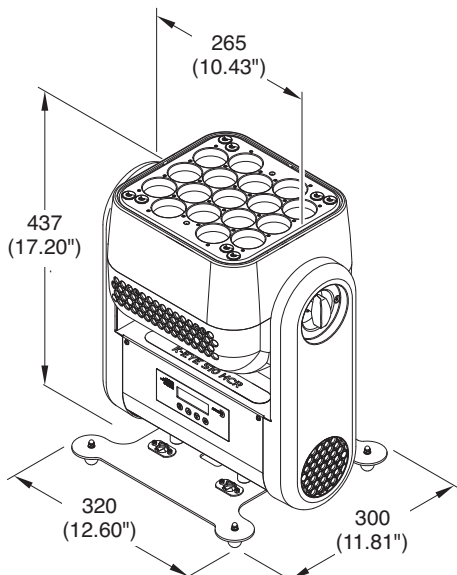
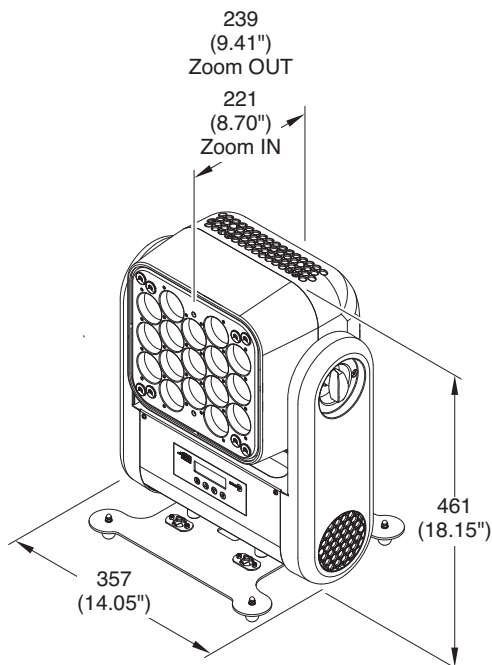

POWER SUPPLIES

100/240V 50/60 Hz

INPUT POWER

300VA

LIGHT SOURCE

Light sources: 6-color LED modules
LED module: R+G+B+Amber+Cyan+Lime
Number of LEDs: 17
LED life expectancy: min. 50,000h
Typical lumen maintenance: 70% @ 50,000 hours
Typical CRI value > 97 up to 99

OPTICS

Optics featuring 6-color LED module system + rod-bar mixing system + front lens
6°- 50° linear electronic Zoom

COLOR SYSTEM

Color system: R+G+B+Cyan+Amber+Lime LED module
Color Temperature control: Linear from 2500K to 8000K (CTO controlled mode plus RAGCB correction)
Control of the colors: RAW mode, HSL mode, RGB mode, CMY mode
- RAW mode Enable specific control of each color
- HSL mode function is based on algorithm. HSL parameters: HUE, HUE fine, Saturation, Crossfade, Path, Tint
- RGB mode The projectors works in the same way as a classical RGB fixture
- CMY mode The projectors works in the same way as a classical CMY fixture
Halo Emulation 750W, 1000W, 1200W, 2000W, 2500W lamp emulation
Gamma Wave: Different chromatic curves for each color
Macro: Dedicated color macro channel with 80 preselected colors

EFFECTS SECTION

Electronic and linear dimmer, 16 bit
Strobe 24 flash/sec. Electronic, instant open and blackout. Variable speed pulsation

CONTROL AND PROGRAMMING

27 DMX 512 control channels
Control signal: USITT DMX 512
Protocols: RDM, WebServer and Art-Net
Display: Graphic LCD backlit b/w display
Display battery: Long life self-charging buffer battery
Pan/Tilt Resolution 16 bit

Dimmer Resolution 16 bit
Movement control: vectorial
DMX signal connection: 3 and 5 pole XLR input and output
Firmware update: Software upload through DMX input

BODY

Structure in aluminium with die-cast plastic cover
Optional frame for external gels and frost filters
Optional top hat (adjustable with the Zoom movement)

ELECTRONICS

Long-life auto-charging buffer battery
Preset color and graphic effect macros
Function reset controllable from a central control unit
Menu-driven internal self-test function
Electronic check-up of every single parameter with error alarm
DMX level monitoring on each channel
Automatic internal data transmission error diagnostics
Firmware upgrade with no power
Firmware transfer from one light to another

SAFETY DEVICES

Minimum distance of illuminated objects: 0.2 meters (8")
Minimum distance from flammable materials: 0.2 meters (8")
Max ambient temperature: 40°C (104°F)
Max temperature of the external surface: 90°C (194°F)
Bipolar circuit breaker with thermal protection
Automatic break in power supply in case of overheating
Forced ventilation with axial fans

CE MARKING

In conformity with the European Directives:
• 2014/35/EU - Safety of electrical equipment supplied at low voltage (LVD)
• 2014/30/EU - Electromagnetic Compatibility (EMC)
• 2011/65/EU - Restriction of the use of certain hazardous substances (RoHS)
• 2009/125/EC - EcoDesign requirements for Energy-related Products (ErP)

WEIGHT

12 Kg (26.45 lbs)

K-EYE S20 HCR

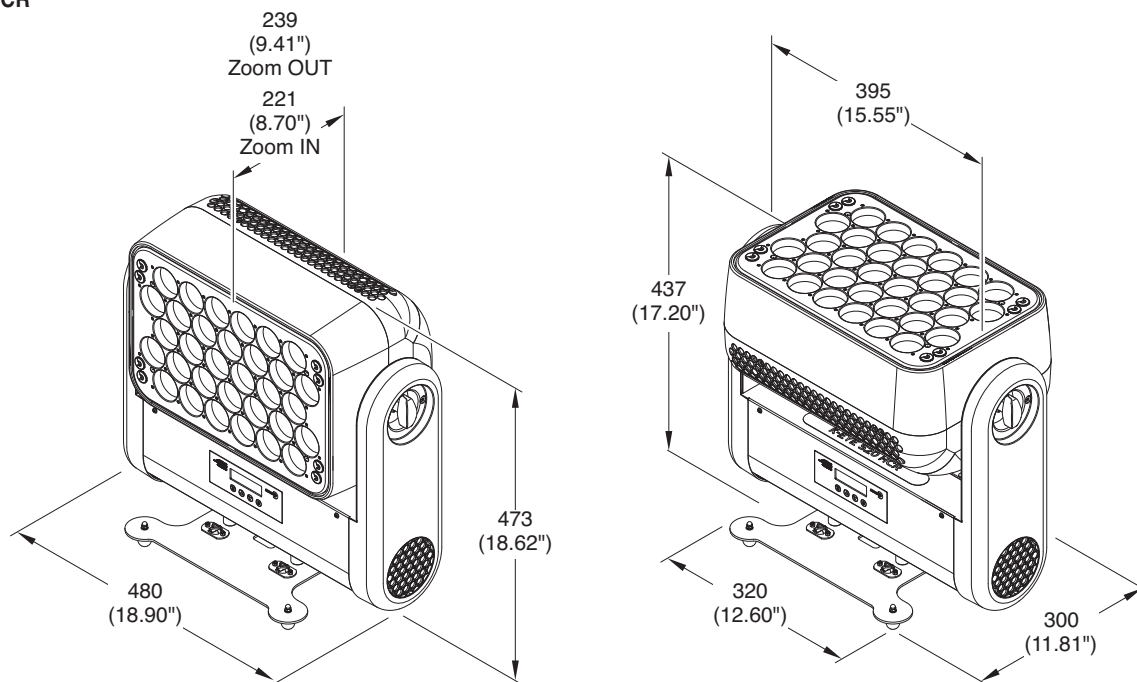

POWER SUPPLIES

100/240V 50/60 Hz

INPUT POWER

500VA

LIGHT SOURCE

Light sources: 6-color LED modules
LED module: R+G+B+Amber+Cyan+Lime
Number of LEDs: 32
LED life expectancy: min. 50,000h
Typical lumen maintenance: 70% @ 50,000 hours
Typical CRI value > 97 up to 99

OPTICS

Optics featuring 6-color LED module system + rod-bar mixing system + front lens
6° - 50° linear electronic Zoom

COLOR SYSTEM

Color system: R+G+B+Cyan+Amber+Lime LED module
Color Temperature control: Linear from 2500K to 8000K (CTO controlled mode plus RAGCB correction)
Control of the colors: RAW mode, HSL mode, RGB mode, CMY mode
- RAW mode Enable specific control of each color
- HSL mode function is based on algorithm. HSL parameters: HUE, HUE fine, Saturation, Crossfade, Path, Tint
- RGB mode The projectors works in the same way as a classical RGB fixture
- CMY mode The projectors works in the same way as a classical CMY fixture
Halo Emulation 750W, 1000W, 1200W, 2000W, 2500W lamp emulation
Gamma Wave: Different chromatic curves for each color
Macro: Dedicated color macro channel with 80 preselected colors

EFFECTS SECTION

Electronic and linear dimmer, 16 bit
Strobe 24 flash/sec. Electronic, instant open and blackout. Variable speed pulsation

CONTROL AND PROGRAMMING

27 DMX 512 control channels
Control signal: USITT DMX 512
Protocols: RDM, WebServer and Art-Net
Display: Graphic LCD backlit b/w display
Display battery: Long life self-charging buffer battery
Pan/Tilt Resolution 16 bit
Dimmer Resolution 16 bit
Movement control: vectorial
DMX signal connection: 3 and 5 pole XLR input and output
Firmware update: Software upload through DMX input

BODY

Structure in aluminium with die-cast plastic cover
Optional frame for external gels and frost filters
Optional top hat (adjustable with the Zoom movement)

ELECTRONICS

Long-life auto-charging buffer battery
Preset color and graphic effect macros
Function reset controllable from a central control unit
Menu-driven internal self-test function
Electronic check-up of every single parameter with error alarm
DMX level monitoring on each channel
Automatic internal data transmission error diagnostics
Firmware upgrade with no power
Firmware transfer from one light to another

SAFETY DEVICES

Minimum distance of illuminated objects: 0.2 meters (8")
Minimum distance from flammable materials: 0.2 meters (8")
Max ambient temperature: 40°C (104°F)
Max temperature of the external surface: 90°C (194°F)
Bipolar circuit breaker with thermal protection
Automatic break in power supply in case of overheating
Forced ventilation with axial fans

CE MARKING

In conformity with the European Directives:
• 2014/35/EU - Safety of electrical equipment supplied at low voltage (LVD)
• 2014/30/EU - Electromagnetic Compatibility (EMC)
• 2011/65/EU - Restriction of the use of certain hazardous substances (RoHS)
• 2009/125/EC - EcoDesign requirements for Energy-related Products (ErP)

WEIGHT

17 Kg (37.48 lbs)