



AN OSRAM BUSINESS

SHOW-BATTEN 100

SHOW-BATTEN 100 AS

C71085

C71086

INSTRUCTIONS MANUAL

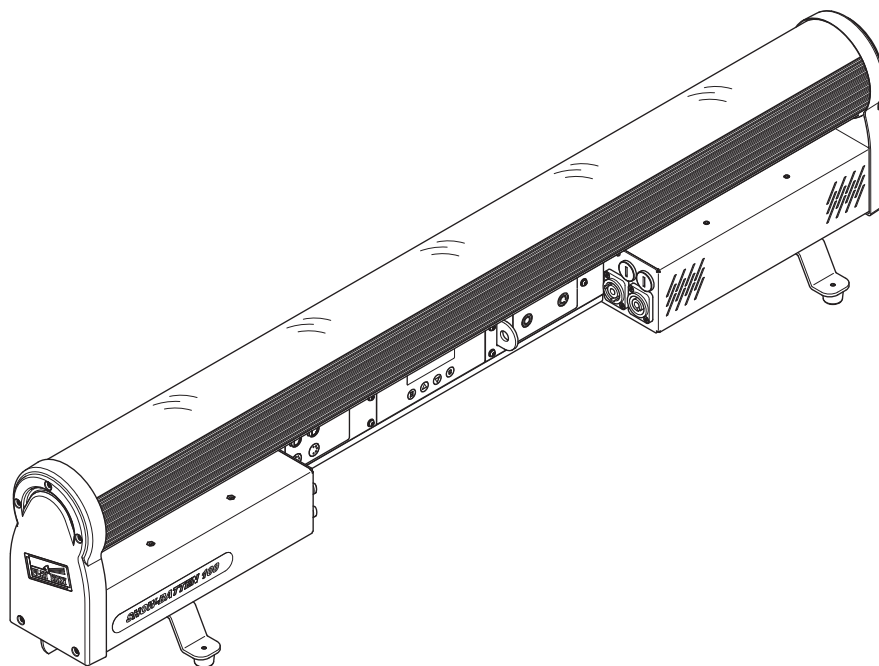

INDEX

Page	Contents
2	Safety Information
3	Unpacking and preparation
3	Removal of the protective film
3	Installation and start-up
5	Control panel
7	Maintenance
10	Technical data
11	Cause and solution of problems

Congratulations on choosing a Clay Paky product!

We thank you for your choice. Please note that this product, as all the others in the rich Clay Paky range, has been designed and manufactured with total quality to ensure excellent performance and best meet your expectations and requirements.

Carefully read this instruction manual in its entirety and keep it safe for future reference.

It is essential to know the information and comply with the instructions given in this manual in order to ensure the fitting is installed, used and serviced correctly and safely.

CLAY PAKY S.p.A. disclaims all liability for damage to the fitting or to the other property or persons deriving from installation, use and maintenance that have not been carried out in conformity with this instructions manual, which must always accompany the fitting.

CLAY PAKY S.p.A. reserves the right to modify the characteristics stated in this instructions manual at any time and without prior notice.

SAFETY INFORMATION

EN

SAFETY INFORMATION

IMPORTANT: Clay Paky recommends you carefully read and keep the safety information on this product, also available in digital format at the following link:

<http://www.claypaky.it/en>

Ref: [FIS000 – Safety Information Show-Batten 100, Show-Batten 100 AS]

IT

INFORMAZIONI DI SICUREZZA

IMPORTANTE: Clay Paky raccomanda di leggere accuratamente e conservare le informazioni di sicurezza relative a questo prodotto, sempre reperibili in versione digitale al seguente link:

<http://www.claypaky.it/en/download>

Rif: [FIS000 – Safety Information Show-Batten 100, Show-Batten 100 AS]

DE

INFORMATIONEN ZUR SICHERHEIT

WICHTIG: Clay Paky empfiehlt, die Sicherheitsinformationen bezüglich dieses Produkts genau zu lesen und aufzubewahren. Sie sind in Digitalversion immer unter folgendem Link auffindbar:

<http://www.claypaky.it/en/download>

Ref: [FIS000 – Safety Information Show-Batten 100, Show-Batten 100 AS]

ES

INFORMACIONES DE SEGURIDAD

IMPORTANTE: Clay Paky recomienda leer detenidamente y conservar la información de seguridad relativa a este producto. Además, está disponible una versión digital de la misma en el siguiente enlace:

<http://www.claypaky.it/en/download>

Ref: [FIS000 – Safety Information Show-Batten 100, Show-Batten 100 AS]

FR

CONSIGNES DE SÉCURITÉ

IMPORTANT: Clay Paky recommande de lire attentivement et de conserver les informations de sécurité relatives à ce produit, disponibles en version digitale au lien suivant:

<http://www.claypaky.it/en/download>

Réf. : [FIS000 – Safety Information Show-Batten 100, Show-Batten 100 AS]

RU

ИНСТРУКЦИЮ ПО ТЕХНИКЕ БЕЗОПАСНОСТИ

ВАЖНО: Clay Paky рекомендует внимательно прочитать и сохранить инструкцию по технике безопасности данного изделия, которая всегда доступна в электронном формате по следующей ссылке:

<http://www.claypaky.it/en/download>

Наименование: [FIS000 – Safety Information Show-Batten 100, Show-Batten 100 AS]

UNPACKING AND PREPARATION

1

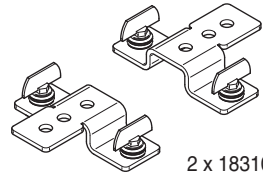
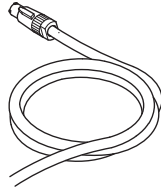

2 x 183102/805

Packing content - Fig. 1

REMOVAL OF THE PROTECTIVE FILM

2

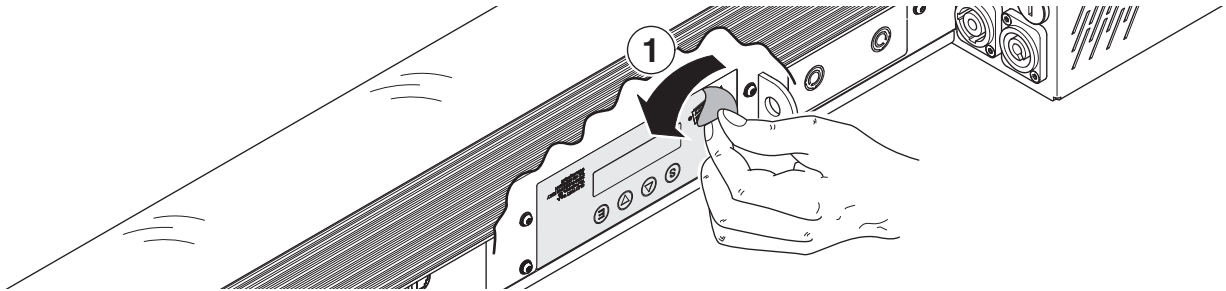

INSTALLATION AND START-UP

3

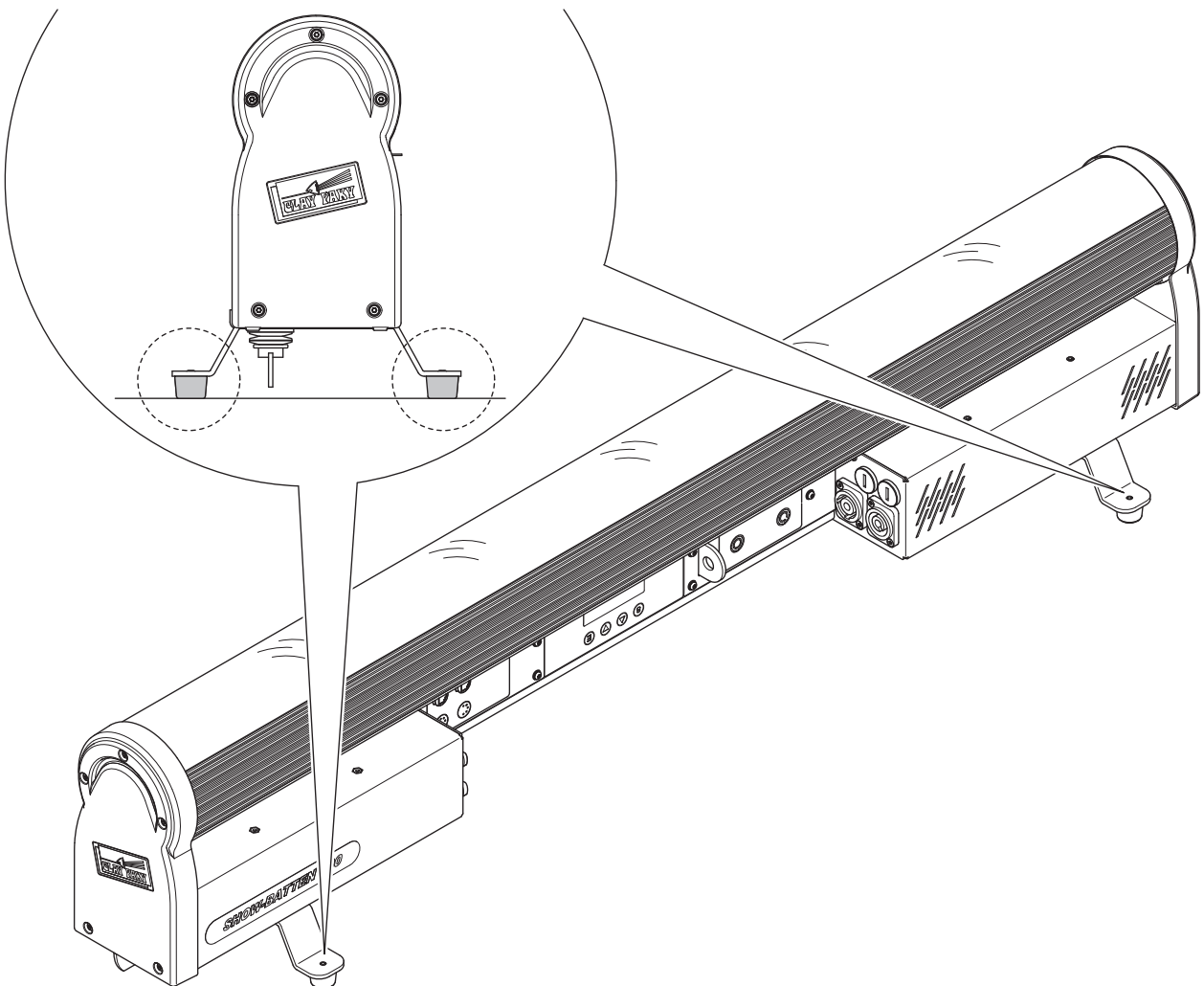

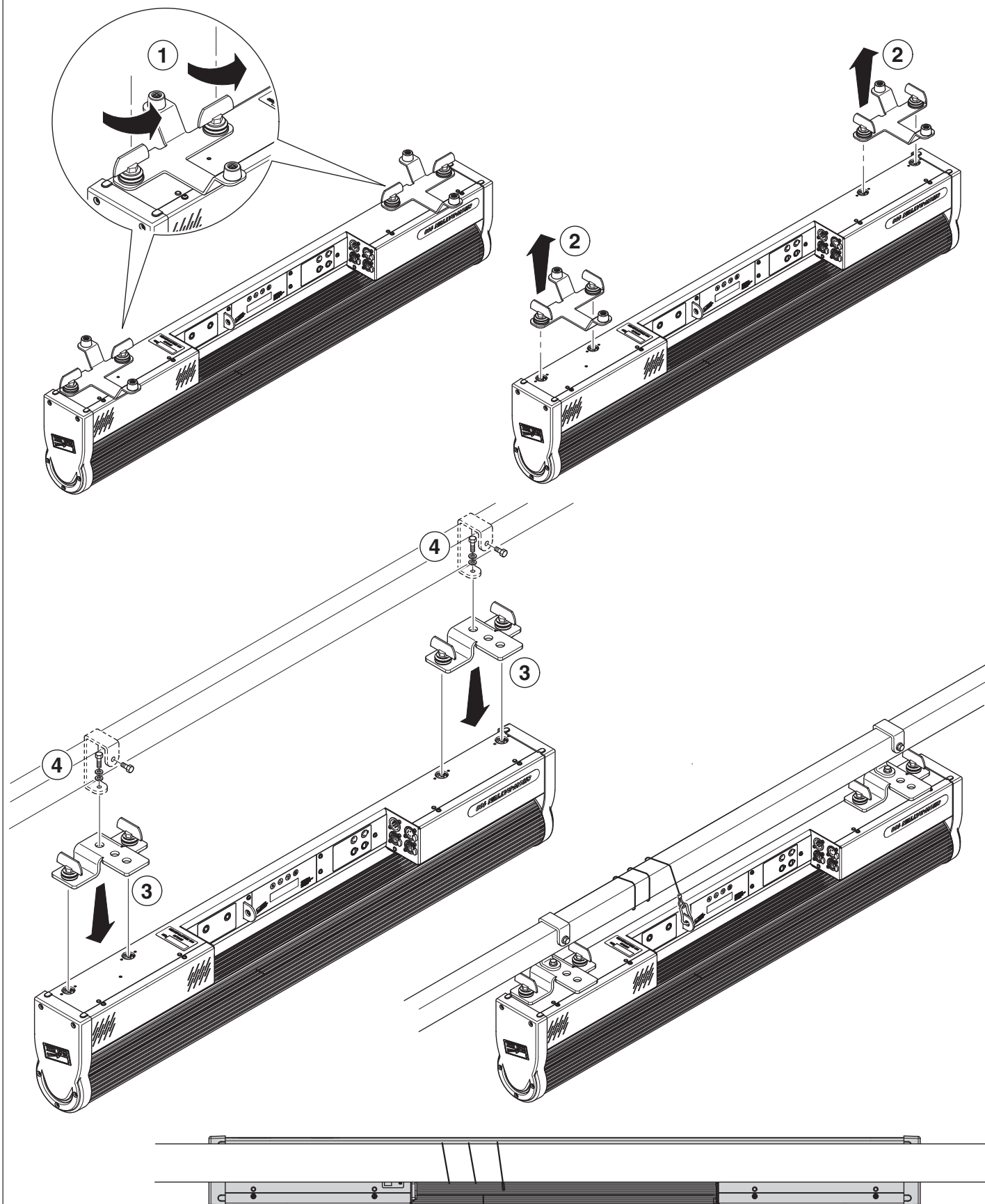

Projector installation - Fig. 4

The projector can be installed on the floor resting on specific rubber feet, on a truss, on the ceiling or wall.

WARNING: the safety chain must be installed except when the projector rests on the floor. (Code 105015/801 available upon request). This must be secured to the projector support structure and then hooked to the fastening point at the centre of the fixture.

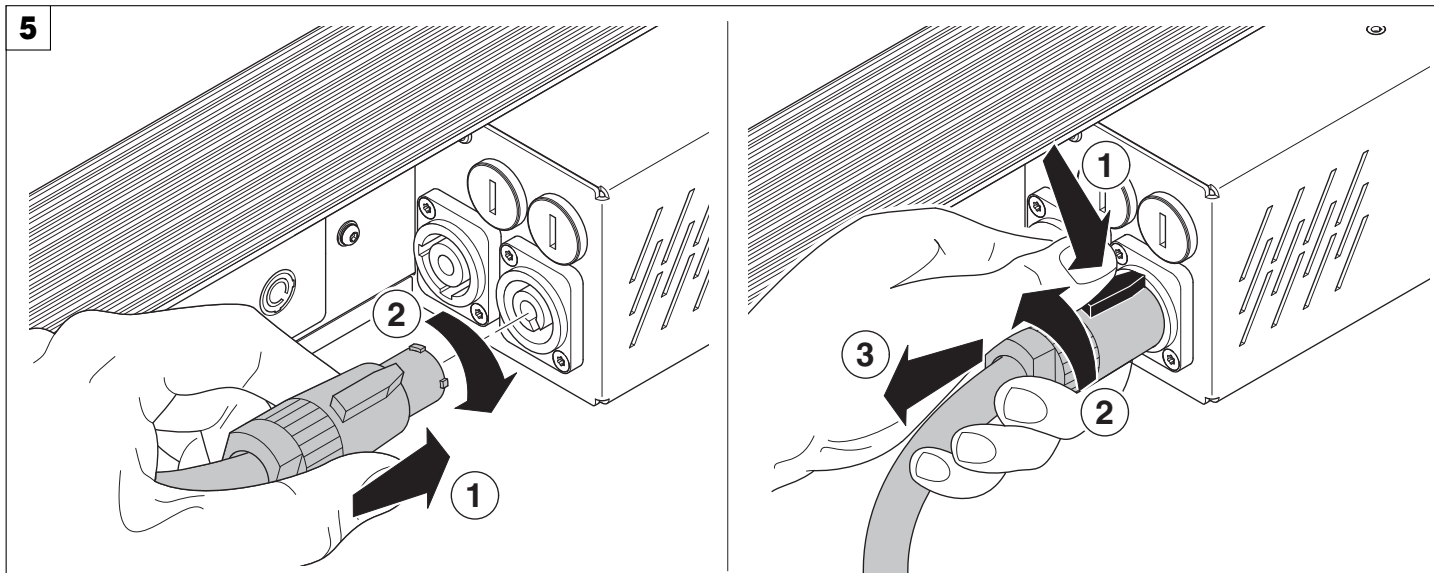

Connecting and disconnecting the power cord - Fig. 5

CONTROL PANEL

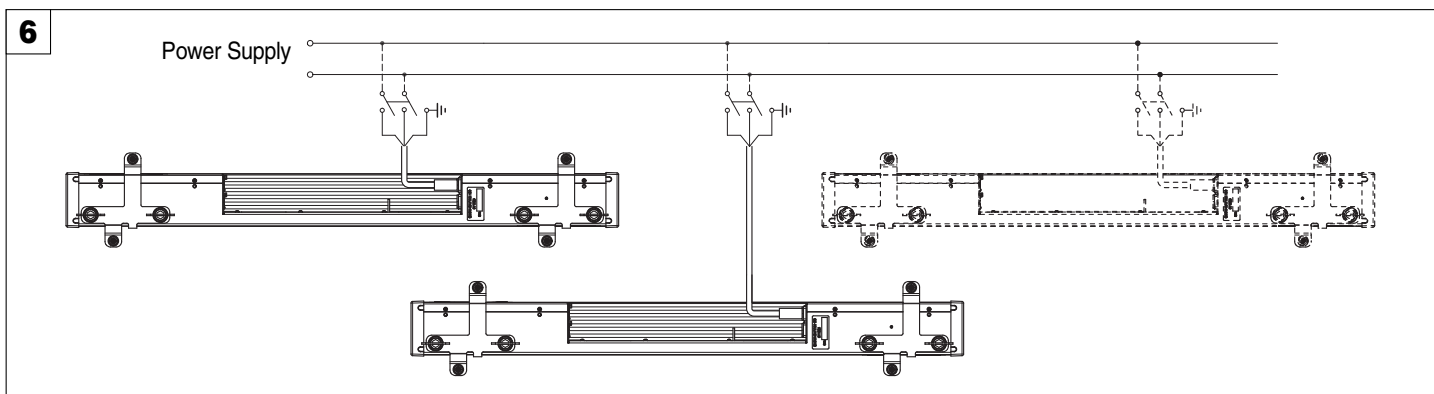

Connections to the power mains - Fig. 6

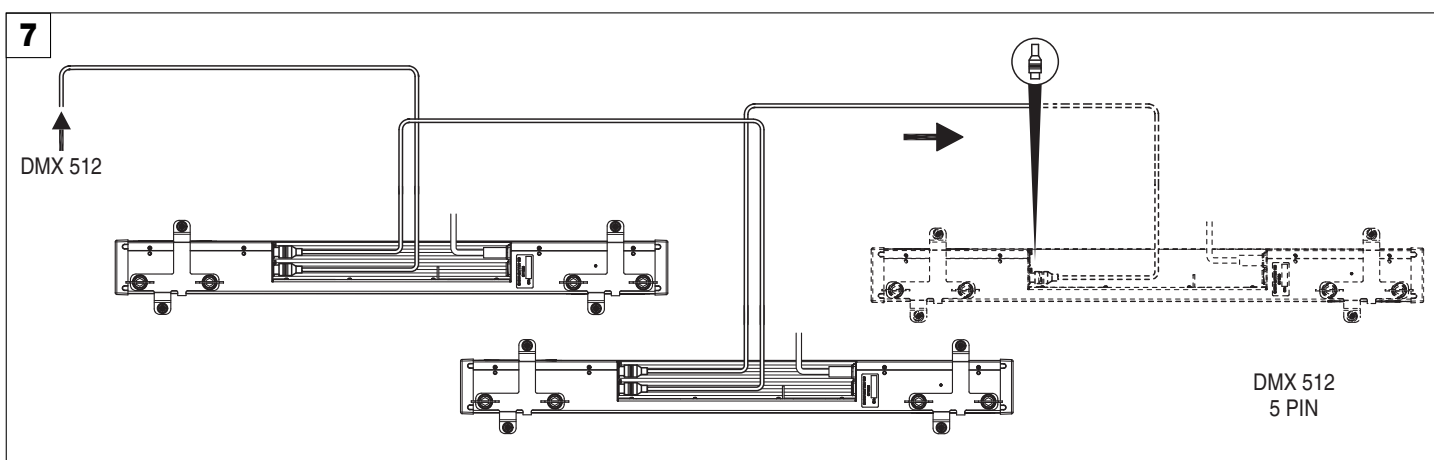

Connections to the control signal line (DMX) - Fig. 7

Use a cable conforming to specifications EIA RS-485: 2-pole twisted, shielded, 120 Ω characteristic impedance, 22-24 AWG, low capacity. Do not use microphone cable or other cable with characteristics differing from those specified. End connections must be made using XLR type 5-pin male/female connectors. A terminating plug must be inserted on the last projector with a resistance of 120 (minimum 1/4 W) between terminals 2 and 3.

IMPORTANT: The wires must not make contact with each other or with the metal casing of the connectors. The casing must be connected to the shield braid and pin 1 of the connectors.

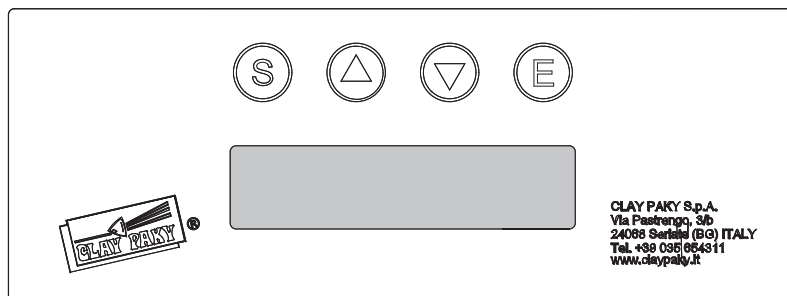

Switching on the projector - Fig. 8

The projector immediately turns on when the power cord is plugged.





Clay Paky SHOW BATTEN 100	SHOW BATTEN 100 Software release x.x x	Address xxx xxxxx ??? *
------------------------------	---	----------------------------

The control panel (Figure 8) has a display and buttons for complete programming and management of the projector menu.

The display can be in one of two conditions: idle status and settings status. When idle, the projector DMX address is displayed.

If no button is pressed after a wait period (about 60 seconds) when in menu settings status, the display automatically returns to idle status. It should be noted that when this condition occurs, any modified value that has not yet been confirmed with the  key will be cancelled.

Button functions – Menu SET

SELECT 	<ul style="list-style-type: none"> • If pressed in idle status: Cyclically switches between idle status and menu settings. • If pressed while setting a menu: Moves to an upper level without changing anything (exits the function)
DOWN 	Decreases the value displayed (with auto-repetitions), or passes to the next item on the menu For quick access to the minimum parameter value, press the UP key while holding down the DOWN key.
UP 	Increases the value displayed (with auto-repetitions), or passes to the previous item on the menu For quick access to the maximum parameter value, press the DOWN key while holding down the UP key.
ENTER 	Confirms the displayed value or activates the displayed function or opens the next menu.

9

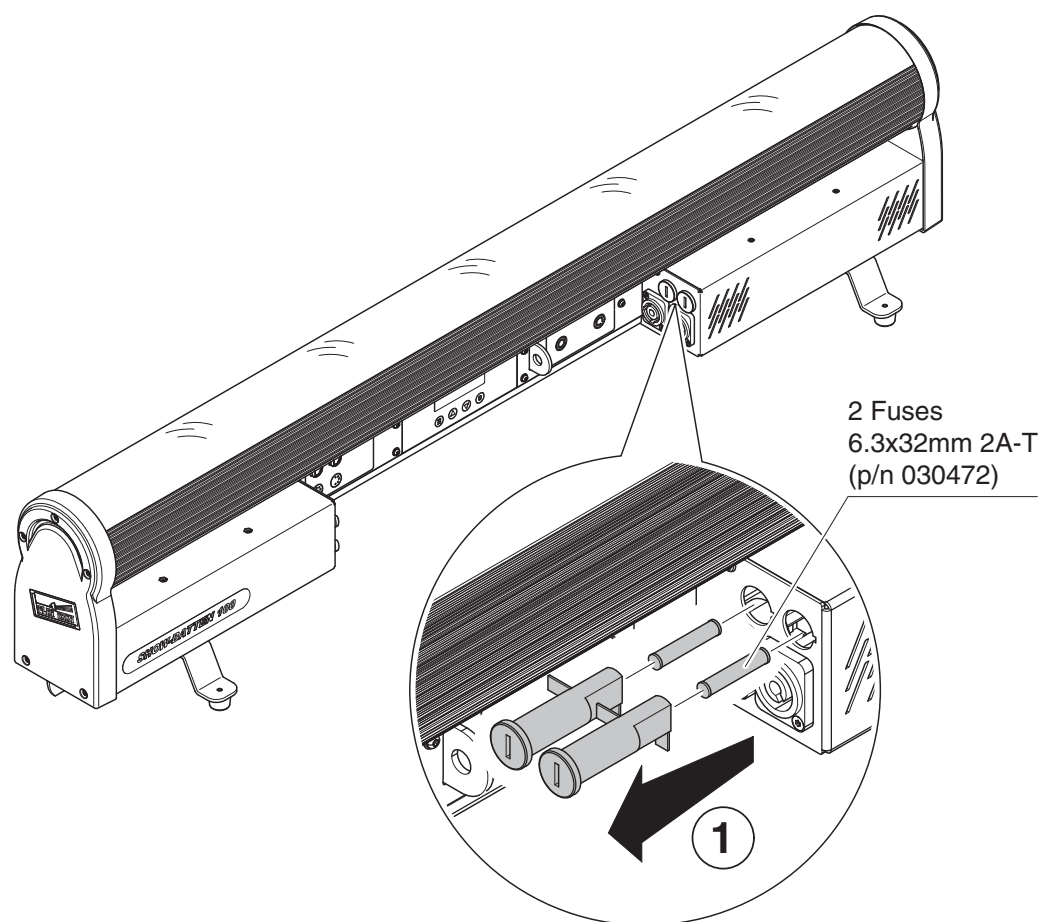

Fuses replacing - Fig. 9

Each Show Batten has 2 fuses associated with the main power cord connection.

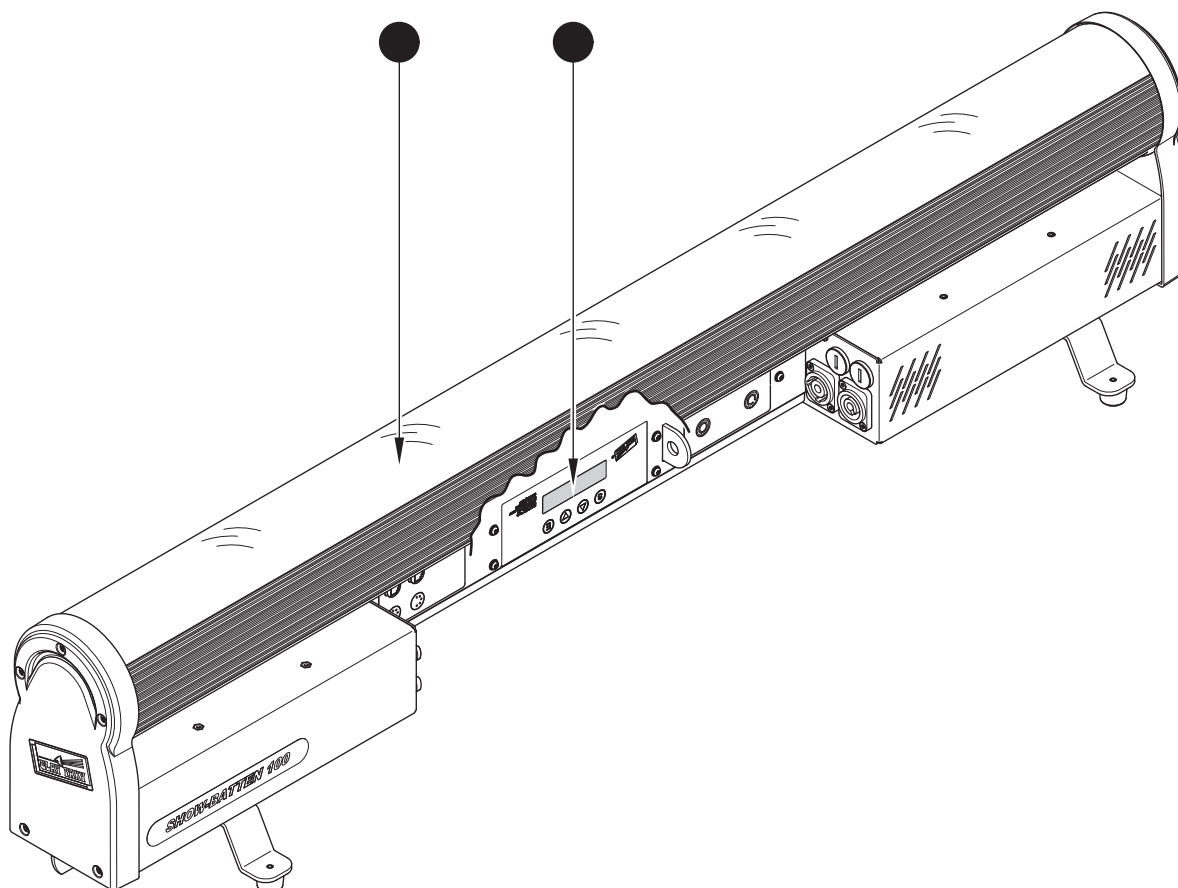

● Parts requiring frequent cleaning.

Periodic cleaning - Fig. 10

To ensure optimal operation and performance for a long time it is essential to periodically clean the parts subject to dust and grease deposits. The frequency with which the following operations are to be carried out depends on various factors such as wear and the work environment quality (air humidity, dust, salinity, etc.). To remove dirt from external parts, use a soft cloth dampened with any liquid glass cleaning detergent.

It is recommended that the projector undergoes an annual service by a qualified technician for special maintenance involving at least the following operations:

- General cleaning of internal parts.
- General visual check of internal parts, cabling, mechanical parts, etc.
- Electrical, photometric and functional checks; eventual repairs.

Cleaning transparent cover

Only use neutral soap and water to clean the transparent cover then dry it carefully with a soft, non-abrasive cloth. (WARNING: the use of alcohol or any other detergent could damage the transparent cover.)

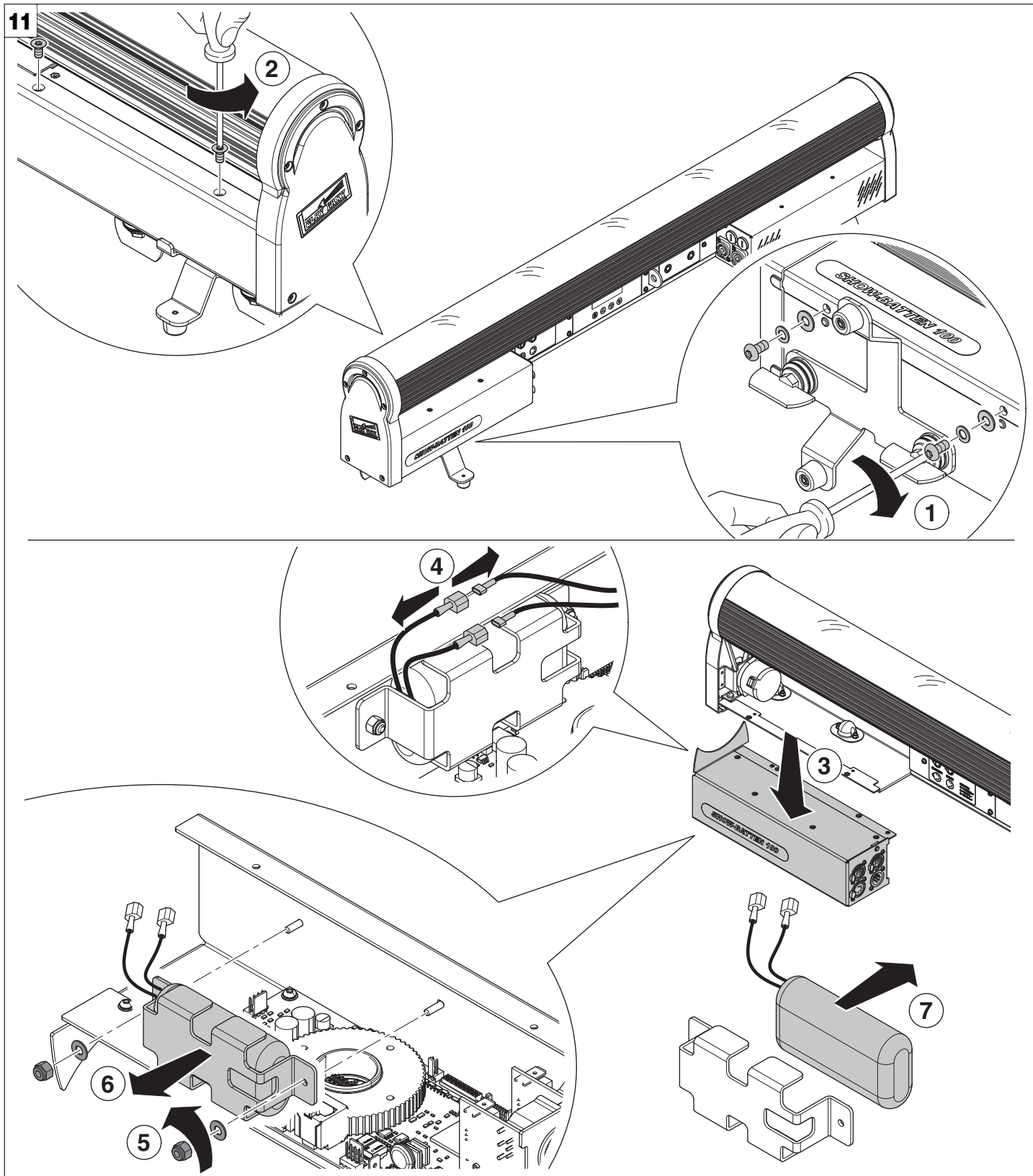

Battery removal - Fig. 11



This product contains a rechargeable lithium iron tetraphosphate battery. To preserve the environment, please dispose the battery at the end of its life according to the regulation in force.

TECHNICAL DATA

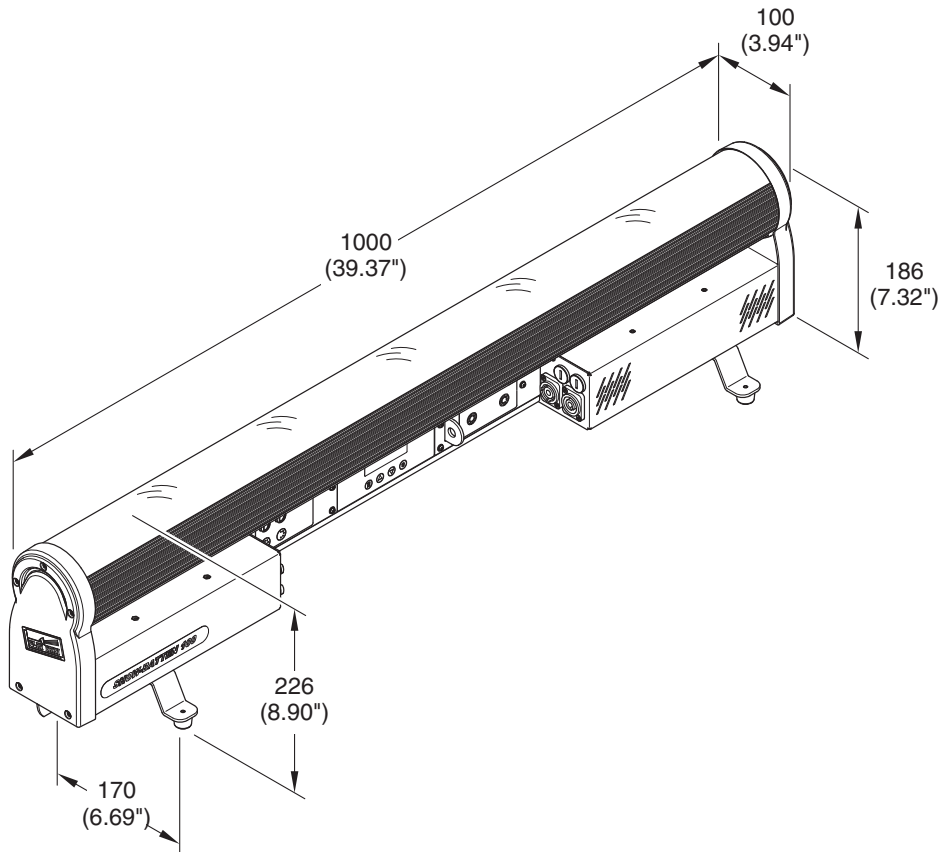

Power supplies

- 100/240V 50/60 Hz
- Automatic power supply

Input power

- 170 VA
- Max 1700VA connecting Max 10 units

Total lumen output

SB100: Max 2.840 lm

SB100AS: Max 2.590 lm

Light source

10x15W LED RGBW

- Type: OSRAM OSTAR - SMT LE RTDUW S2W
- Color Temperature: 6.000 K
- Life: 50.000 hrs
- Luminous flux: 6.800 lm

Motors

3 stepper motors, operating with micro steps, totally microprocessor controlled

Control inputs

- DMX 512
- ART-NET

Moving body

Automatic repositioning of TILT after accidental movement not controlled by control unit.

TILT

- Angle rotation: 240°
- Fast speed: 0,2 sec
- Resolution tilt: 0,94

Weight

10 Kg (22 lbs)

IP rating

- IP20
- Protected against the entry of solid bodies larger than 12mm (0,47")
- No protection against the entry of liquids

Safety devices

- Automatic shut-down in case of power supply overcurrent or overheating
- Automatic derating, in case of LED overheating or failed operation of cooling system

Cooling

Forced ventilation with fans and heat sink

Body

- Body extruded in black anodized aluminum
- Aluminum and steel structure with plastic covers

Working position

- Any working position
- Hanging system: with fast-lock omega clamps (1/4 turn) on the base

Color system and effects section:

- Individual color RGBW control for each LED
- Global dimmer
- Color temperature control from 2.500 K to 8.000 K
- Strobe from 1 to 20 flashes/sec
- Random and macro strobe
- Macro color

Control and programming:

- DMX protocol signal: USITT DMX 512
- Display: LCD 2 lines with 16 characters each, backlit LED, white on black
- Tilt Resolution: 16 bit
- Dimmer Resolution: 16 bit
- Strobe 20Hz
- DMX signal connection: 5 pole XLR input and output
- Software upload through DMX input

Electronics

- Long life self-charging buffer battery
- Electronic monitoring with status error
- Cooling system monitoring
- DMX level monitoring on all channels
- Internal data transmission diagnostics
- Firmware upgrade with no power
- Firmware upload from another fixture

CAUSE AND SOLUTION OF PROBLEMS

THE PROJECTOR WILL NOT SWITCH ON				TROUBLE
THE PROJECTOR WILL NOT SWITCH ON				
DEFECTIVE PROJECTION				
REDUCED LUMINOSITY				
POSSIBLE CAUSES				CHECKS AND REMEDIES
●			No power supply.	Check the power supply voltage.
●		●	LED burnt out or defective.	Call an authorised technician.
	●		Signal transmission cable faulty or disconnected.	Replace the cables.
	●		Incorrect addressing.	Check addresses (see instructions).
	●		Fault in the electronic circuits.	Call an authorised technician.
		●	Optic fault.	Call an authorised technician.
		● ●	Dust or grease deposits.	Clean (see instructions).

